



8X2:3 IN-CTRL™ DUAL SCALER SEAMLESS SWITCHER



DESCRIPTION

The VP-727xl In-CTRL™ Dual Scaler Seamless Switcher is a true multi-standard video to graphics scaler and seamless switcher with 8 universal inputs comprised of 5 BNCs each of which can accommodate a composite video, s-Video (Y/C), component video (RGB/YUV), RGBS, or RGBHV signal. Inputs 1 and 2 also can be configured to HDMI inputs. The unit has dual scalers, one for the preview and the other for the program output. Dual scalers are required to do "True" seamless transitions from one source to another.

- Dual Scalers with Preview and Program Outputs - Perfect for live productions. Preview and Program signals are each simultaneously output on an HDMI connector and as an RGBHV/YUV signal on both a set of 5 BNC connectors and an 15-Pin HD connector.
- HDCP Compliant - The HDCP (High Definition Content Protection) license agreement allows copy-protected data on the HDMI input to pass only to the HDMI output.
HDTV Compatible.
- K-Storm™ Scaling Technology Kramer's extremely high performance scaling technology. High quality 3:2 and 2:2 pull down de-interlacing and full up and down scaling of computer graphics and video input signals.
- True Seamless Switching with FX - With the incorporation of two scalers, the unit can switch absolutely seamlessly between 2 live sources. Transitions include cut and fade plus numerous other effects each with multiple variations and speeds.
- K-IIT™ Picture-in-Picture Image Insertion Technology - Ultra stable picture-in-picture image insertion capability. Any video source can be inserted into a computer graphics video source and vice versa with positioning and sizing controls available to the user. A unique Split-Screen mode is also available.
- Companion Audio Switcher Available - The VP-727A is an 8x2:3 stereo audio companion switcher for the VP-727(xl). The unit switches eight unbalanced stereo audio inputs to the selected preview and program outputs.
- Take Button - Execute preview to program switching (with transition effect).
- Text Overlay.
- 8 Universal Video Inputs - Each input has 5 BNC's which can be configured to accept composite video, s-Video (Y/C), component video (RGB/YUV), RGBS, or RGBHV signals. Inputs 1 & 2 can be switched to HDMI input connectors.
- Multiple Computer Graphics Output Resolutions - including a user-defined output resolution with selectable refresh rates.
- HDTV Output Resolutions - 480p, 576p, 720p, 1080i and 1080p in component format on all output connectors.

Multi-Standard - PAL, SECAM & NTSC (3.58/4.43).

- Multiple Aspect Ratio Selections - 4x3 or 16x9, anamorphic, letter box, and user definable settings.
- Built-in Time Base Corrector - Stabilizes video sources with unstable sync.
- Multiple Color Space - Output RGB or YUV (Selectable).
- Built-in Proc-Amp - Color, hue, sharpness, contrast, and brightness are set individually for each input.
- Front Panel Lockout.
- Video Blanking - Blue or black screen selectable.
- Freeze Frame.
- Zoom (100% to 400%).
- Flexible Control Options - Front panel buttons, IR. Remote (with on-screen menus), Ethernet, RS-232 & RS-485.
- Worldwide Power Supply - 100-240V AC.
- 'Standard 19" Rack Mount Size - 3U. Rack 'ears' included.

Page 1 of 2

© www.kramerelectronics.com 2009

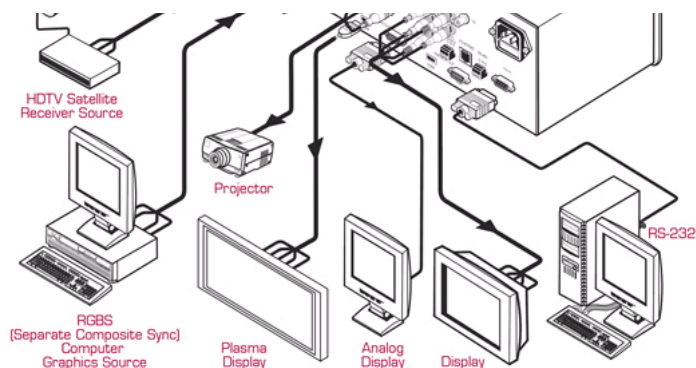

HD15F connector 1 x RGBHV / YPbPr on BNC connectors

CONTROLS:

Front panel buttons, high contrast LCD, IR remote control, ETHERNET, AUDIO CONTROL, RS-232, RS-485, and optional T-bar remote controller

ADDITIONAL CONTROLS:

Freeze, zoom, different selectable vertical refresh rates, ProcAmp control, output image scaling, Picture-In-Picture, text overlay, and aspect ratio change

POWER SOURCE:

100-240 VAC, 50/60Hz 55VA

DIMENSIONS:

19" (W), 9.3" (D), 3RU (H) rack mountable

WEIGHT:

5.5 kg. (12.2 lbs.) approx.

ACCESSORIES:

IR remote control, power cord

OPTIONS:

Control panel