

INSTALLATION INSTRUCTIONS

CEILING PLATE

CMA-330

The Ceiling Plate is designed for ease of installation with any height of drop ceiling. Using any length of standard NPT 1½” pipe threaded both on ends. You can extend the height capabilities to meet your needs

WARNING: IMPROPER INSTALLATION MAY RESULT IN SERIOUS PERSONAL INJURY!

All components must be securely fastened to a structural member capable of supporting five times the combined weight of all components plus the equipment being mounted. If it cannot support this weight, the structure **MUST** be reinforced.

The maximum weight to be installed on the column is 500 lbs (226.8 kg).

PARTS:

- | | |
|-------------------------------------|-------------------------------------|
| (1) Ceiling Plate | (1) 5/16-18 x ¼” Security Set Screw |
| (1) 5/16-18 x 3/8” Socket Set Screw | (1) 5/32” Security Hex Key |

INSTALLATION INSTRUCTIONS

1. Securely install the ceiling plate to the ceiling or ceiling joists (**NOTE: SEE WARNING!!**) Bolt hole spacing is shown on Figure 1.
2. Thread your standard NPT 1½” pipe into the coupler and tighten securely.
3. Install and securely tighten the 5/16-18 x 3/8” socket set screw or 5/16-18 x ¼” security set screw.
4. Follow the Ceiling Mount Instructions for installation and adjustment of the projector.

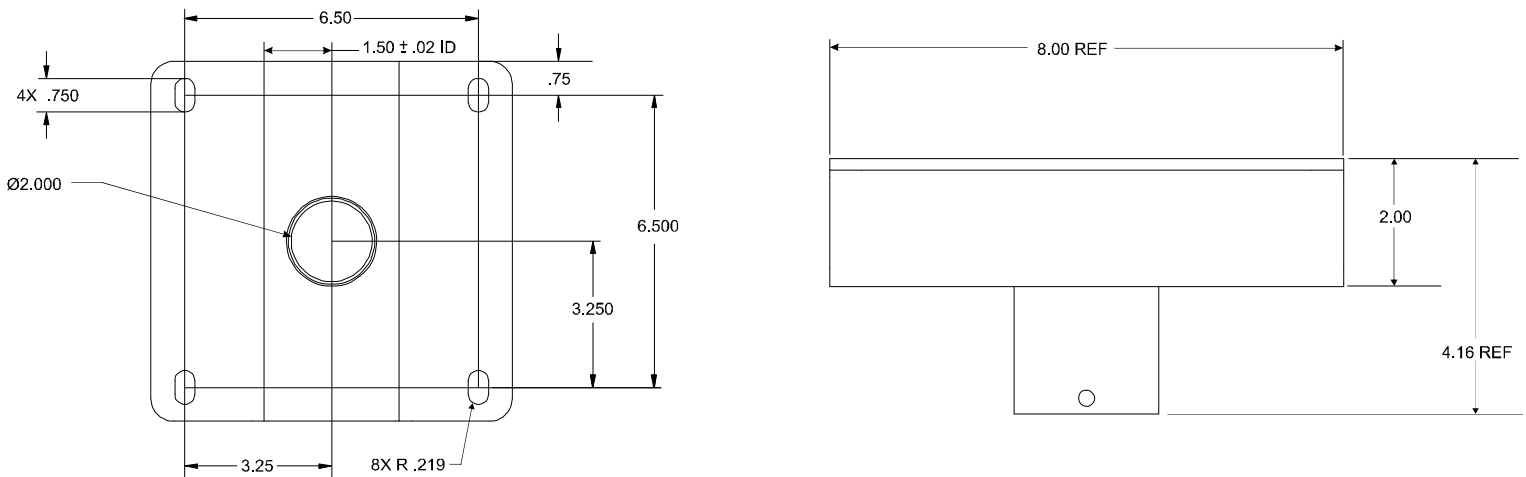

Figure 1. CMA-330 Ceiling Plate

Chief® is a registered trademark of Milestone AV Technologies. All rights reserved.

