

**To:** Panasonic Projector Resellers  
**From:** Scott Wellington, Sr. Product Marketing Manager  
**Subject:** NEW PT-DZ21KU Projector Series Mounting Frame (ET-PFD550)  
**Bulletin Number:** Projector-2012-PB-21  
**Date:** November 1, 2012

We are pleased to announce the availability of a new mounting frame designed for use with the PT-DZ21KU Series large venue projectors. If you have any questions regarding the mounting frame or optional mounting hardware, please contact your Panasonic Sales Representative.

**ET-PFD550 Premium Mounting Frame**

- Designed for use with PT-DZ21KU, PT-DS20KU and PT-DW17KU large venue projectors

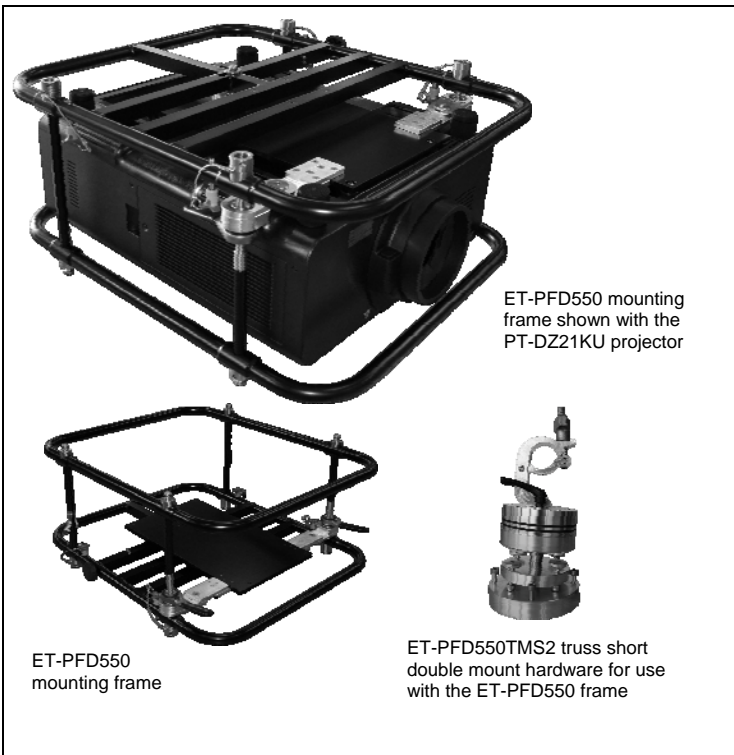

▲ ET-PFD550 shown with the ET-PFD550TMS2 truss short double mount hardware and PT-DZ21KU projector.

<u>Model</u>	<u>Description</u>
ET-PFD550	Mounting Frame
ET-PFD550TMS2	Truss Mount Hardware
.....	

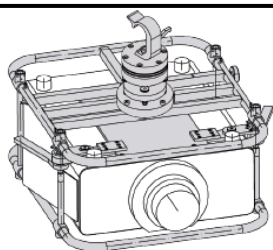

One frame with truss mount hardware

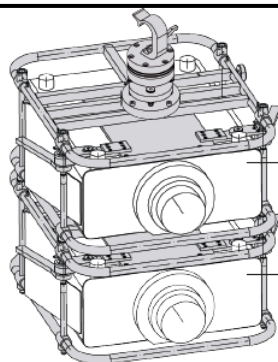

Upper projector

Lower projector

Two stacked frames with truss mount hardware

The ET-PFD550 mounting frame is designed for use with Panasonic's PT-DZ21KU Series projectors and can also be used in a dual stack configuration in which two projectors are used together. Only a qualified installer should install this product.

**For questions contact your Partner Sales Manager or Inside Partner Sales Support:  
 resellersupport@us.panasonic.com, 877.826.6538.**

**ET-PFD550 MOUNTING FRAME SPECIFICATIONS**

**Weight (Gross / Net):**

48.50 lbs. / 41.89 lbs.

**Dimensions:**

Gross (L x W x H): 30.71" x 35.43" x 18.11"

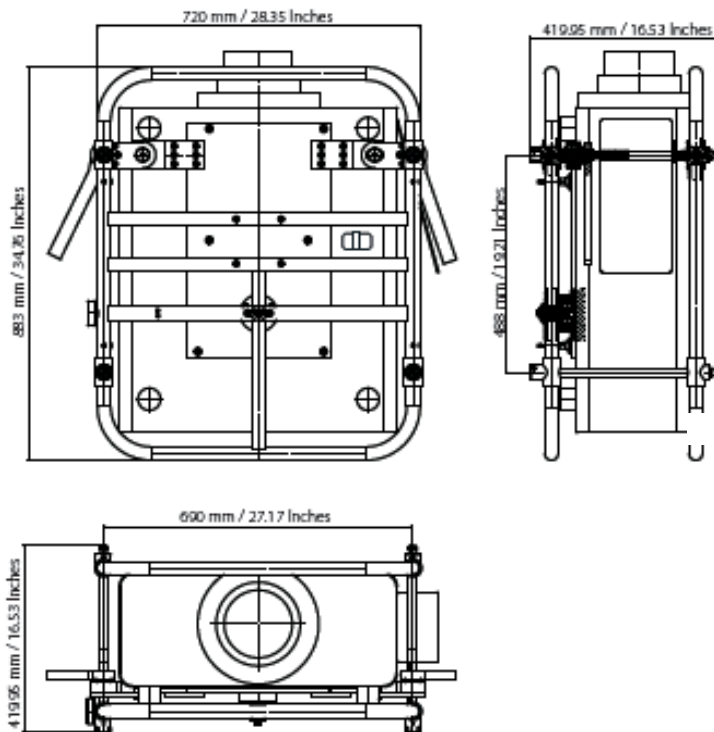

**ET-PFD550TMS2 TRUSS MOUNT SPECIFICATIONS**

**Weight (Gross / Net):**

15.10 lbs. / 14.33 lbs.

**Dimensions:**

Gross (L x W x H): 12.59" x 7.48" x 7.87"

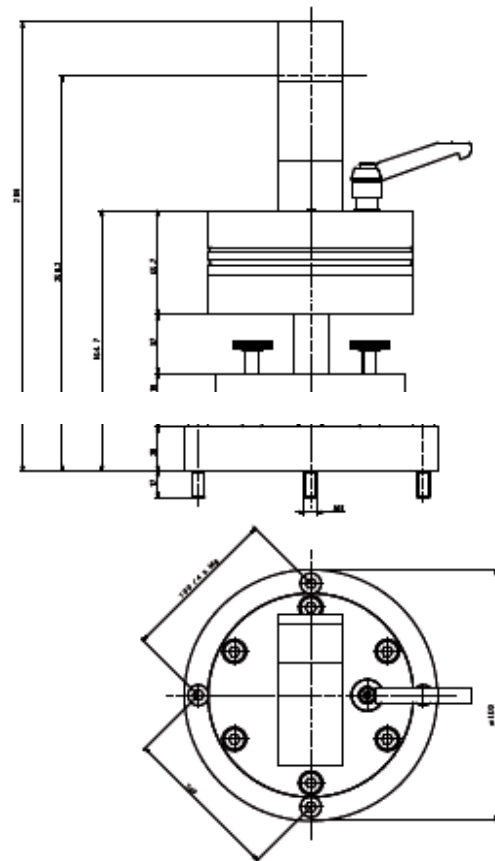

Specifications and appearance are subject to change without notice.

Suggested List Price (SLP) indicates the price at which we believe our products can be most successfully merchandised. No representation is hereby made that substantial sales are or will be made at the Suggested List Price.

For more information about Panasonic projectors please visit; <http://panasonic.net/avc/projector>

**For questions contact your Partner Sales Manager or Inside Partner Sales Support:  
resellersupport@us.panasonic.com, 877.826.6538.**