

IN1146

User's Guide

Guide de l'utilisateur

Benutzeranleitung

Guía del usuario

Guida per l'utente

Gebruikershandleiding

Guia do Usuário

Användarhandbok

Przewodnik Użytkownika

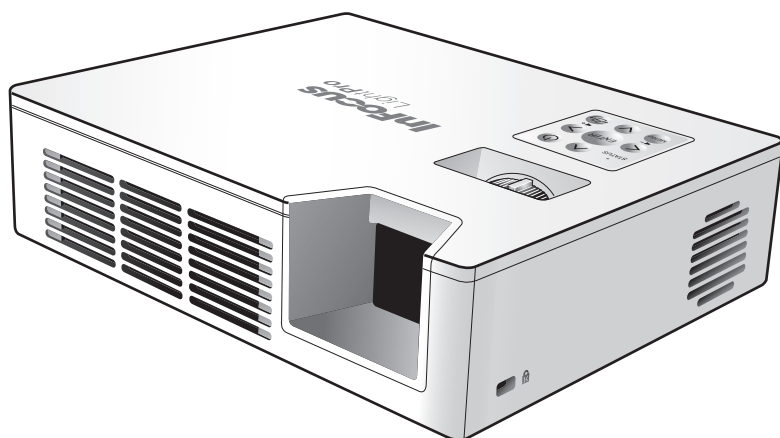

InFocus
LightPro



Eye Safety Warnings

- ⚠ Avoid staring/facing directly into the projector beam at all times. Keep your back to the beam as much as possible.
- ⚠ A stick or laser pointer is recommended to avoid the need for the user to enter the beam.
- ⚠ When projector is used in a classroom, adequately supervise students when they are asked to point out something on the screen.
- ⚠ In order to minimize power, use room blinds to reduce ambient light levels.

Important Safety Instruction

1. Do not block any ventilation openings. To ensure reliable operation of the projector and to protect from overheating, it is recommended that you install the projector in a location that does not block ventilation. For example, do not place the projector on a crowded coffee table, sofa, bed, etc. Do not put the projector in an enclosure such as a book case or cabinet that restricts air flow.
2. Do not use the projector near water or moisture. To reduce the risk of fire and/or electric shock, do not expose the projector to rain or moisture.
3. Do not install near heat sources such as radiators, heaters, stoves or any other apparatus such as amplifiers that emits heat.
4. Do not use the projector in direct sunlight.
5. Do not use near any appliance generating a strong magnetic field.
6. Do not use the projector in areas susceptible to excessive dust and dirt.
7. Turn off the product before cleaning.
8. Disconnect the power cord if the product is not being used for a long period of time.
9. Ensure that the ambient room temperature is within 0- 40°C (32-104°F).
10. Ensure that relative humidity is 5 - 35°C (41- 95°F), 80% (Max.), non-condensing.
11. Do not drop, throw or try to bend your product.
12. Dispose of your projector in an environmentally appropriate manner and according to local disposal laws. Disposing the projector in a fire may cause an explosion.
13. Clean only with dry cloth.
14. Only use attachments/accessories specified by the manufacturer.
15. Do not use the unit if it has been physically damaged or abused. Physical damage/abuse would be (but not limited to):
 - ⇒ Unit has been dropped.
 - ⇒ Charger or plug has been damaged.
 - ⇒ Liquid has been spilled on to the projector.
 - ⇒ Projector has been exposed to rain or moisture.
 - ⇒ Something has fallen in the projector or something is loose inside.Do not attempt to service the unit yourself. Opening or removing covers may expose you to dangerous voltages or other hazards. Please contact your local reseller or service center before you send the unit for repair.
16. Do not let objects or liquids enter the projector. They may touch dangerous voltage points and short out parts that could result in fire or electric shock.
17. Follow all warnings and cautions in this manual and on the projector.
18. The unit should only be repaired by appropriate service personnel.
19. Do not touch the projector for a long time while the projector is used.

CAUTION
RISK OF EXPLOSION IF BATTERY IS REPLACED
BY AN INCORRECT TYPE.
DISPOSE OF USED BATTERIES ACCORDING
TO THE INSTRUCTIONS.

Copyright / Trademark

© Copyright 2013. All rights reserved.

The manufacturer reserves the right to make technical changes. The manufacturer assumes no liability for damages incurred directly or indirectly from errors, omissions, or discrepancies between the device and this documentation.

Other brands or logos are trademarks or registered trademarks of their respective companies.

This device is not intended for use in the direct field of view at visual display workplaces.

DECLARATION OF CONFORMITY

Manufacturer: InFocus Corporation, 13190 SW 68th Parkway, Portland, Oregon 97223-8368 USA

We declare under our sole responsibility that this projector conforms to the following directives and norms:

EMC Directive 2004/108/EC

ErP Directive 2009/125/EC

EMC: EN 55022: 2010

EN 55024: 2010

EN 61000-3-2: 2006+A2:2009

EN 61000-3-3:2008

Low Voltage Directive 2006/95/EC

Safety: IEC 60950-1:2005; EN 60950-1:2006+A12:2011

TRADEMARKS

Apple, Macintosh, iPod, iPod nano, and iPhone are trademarks or registered trademarks of Apple Computer, Inc. IBM is a trademark or registered trademark of International Business Machines, Inc.

DLP® and the DLP logo are registered trademarks of Texas Instruments and BrilliantColor™ is a trademark of Texas Instruments. Microsoft, PowerPoint, and Windows are trademarks or registered trademarks of Microsoft Corporation. Adobe and Acrobat are trademarks or registered trademarks of Adobe Systems Incorporated. InFocus, In Focus, and INFOCUS (stylized) are either registered trademarks or trademarks of InFocus Corporation in the United States and other countries.

NOTE: This product is covered electrical and electronic equipment under the European Union's Waste from Electrical and Electronic Equipment ("WEEE") Directive (2002/96/EC). The WEEE Directive requires that covered equipment be collected and managed separately from typical household waste in all EU member states. Please follow the guidance of your local environmental authority or ask the shop where you purchased the product for collection or recycling options.

FCC WARNING

This device complies with part 15 of the FCC Rules. Operation is subject to the following two conditions: (1) This device may not cause harmful interference, and (2) this device must accept any interference received, including interference that may cause undesired operation.

Note: This equipment has been tested and found to comply with the limits for a Class B digital device, pursuant to part 15 of the FCC Rules. These limits are designed to provide reasonable protection against harmful interference in a residential installation. This equipment generates, uses and can radiate radio frequency energy and, if not installed and used in accordance with the instructions, may cause harmful interference to radio communications. However, there is no guarantee that interference will not occur in a particular installation. If this equipment does cause harmful interference to radio or television reception, which can be determined by turning the equipment off and on, the user is encouraged to try to correct the interference by one or more of the following measures:

--Reorient or relocate the receiving antenna.

--Increase the separation between the equipment and receiver.

--Connect the equipment into an outlet on a circuit different from that to which the receiver is connected.

--Consult the dealer or an experienced radio/TV technician for help.

Changes or modifications not expressly approved by InFocus Corporation may void authority to operate the equipment.

CANADA

This Class B digital apparatus complies with Canadian ICES-003. Cet appareil numérique de la classe B est conforme à la norme NMB-003 du Canada.

AGENCY APPROVALS

FCC, CE, and CB

Other specific Country Approvals may apply. Please see product certification label.

This document applies to regulatory model IN1146.

Input ratings: AC 110-240V, 9-4A, 50-60Hz

InFocus reserves the right to alter product offerings and specifications at any time without notice.

PRODUCT OVERVIEW

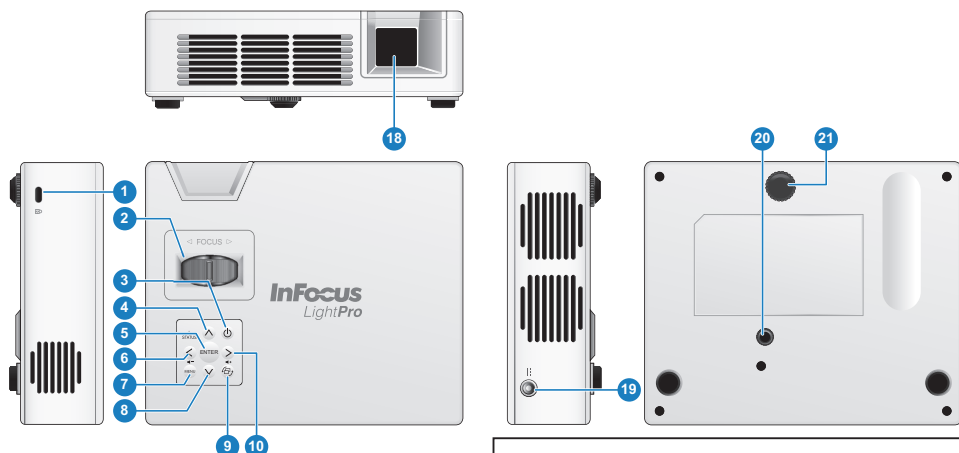

1. Kensington Lock
2. Focus Dial
3. Power Button (⏻)
4. Up Button (▲)
5. Enter Button (ENTER)
6. Left Button (◀)
7. Menu Button (MENU)
8. Down Button (▼)
9. Auto Source Button (⌂)
10. Right Button (▶)
11. IR Receiver
12. Audio Output Connector
13. A/V Input Connector
14. SD Card Slot
15. HDMI Connector
16. USB Connector
17. VGA Connector
18. Lens
19. DC Input
20. Screw Hole for Tripod
21. Elevator Foot

Note
Items 4~10 are also function buttons. Functions vary depending on the current mode.

Remote Control

1. Power Button
2. Up Button
3. Auto Source Button
4. Menu Button
5. Enter Button
6. Left Button
7. Right Button
8. Zoom Button
9. Aspect Ratio Button
10. Down Button
11. PC Button / Conference clear
12. HDMI Button
13. Component (YPbPr) Button
14. Video Button / Theater tune
15. WiFi Button
16. SD/USB Button

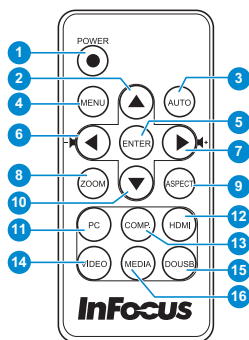

Note
WiFi and SD/USB buttons do not work in EZ Suite mode.

ACCESSORY OVERVIEW

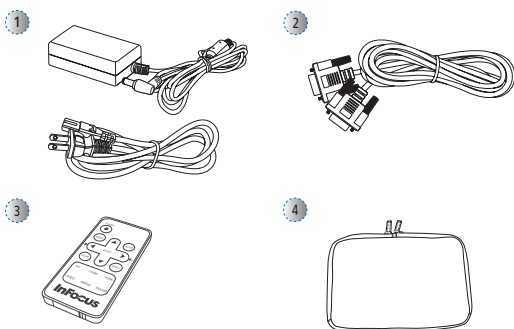

Standard Accessory

1. Power cord / AC adaptor
2. VGA cable
3. Remote control (batteries not included)
4. Carrying case

Note
• The standard accessories may vary in each region due to different applications.
• The inclusive power cord varies per region.
• CR2025 battery required for remote control.

POWER ON / OFF

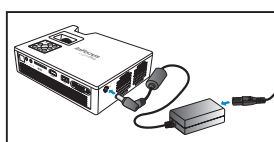

1. Connect the power cord to the DC input jack on the rear of the projector.

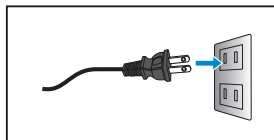

2. Insert the plug at the other end of the power cord into a power outlet.
The status LED lights red in standby mode.

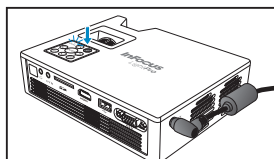

3. Press the Power button (⏻) to turn the projector on or off.
The status LED turns green when the projector is turned on.

ADJUST PROJECTED IMAGE HEIGHT

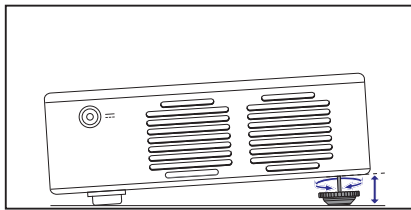

The projector is equipped with an elevator foot for adjusting the projected image height.

To adjust the height:

Turn the elevator foot to adjust the projected image position to the desired height.

Note

If Auto Keystone is enabled and there are no changes within 2-3 seconds, the projector will automatically adjust the image display via the Auto Keystone function.

ADJUST THE PROJECTED IMAGE

Screen Size - Diagonal		Projection Distance		Screen Size - Width		Screen Size - Height	
(D)		(A)		(B)		(C)	
(inch)	(mm)	(inch)	(meter)	(inch)	(mm)	(inch)	(mm)
20	508	23.62	0.60	16.97	431	10.59	269
40	1016	47.64	1.21	33.94	862	21.18	538
60	1524	71.26	1.81	50.87	1292	31.81	808
80	2032	94.88	2.41	67.83	1723	42.40	1077
100	2540	118.90	3.02	84.80	2154	52.99	1346
120	3048	142.52	3.62	101.77	2585	63.58	1615
140	3556	166.14	4.22	118.70	3015	74.21	1885
160	4064	189.76	4.82	135.67	3446	84.80	2154
180	4572	213.78	5.43	152.64	3877	95.39	2423

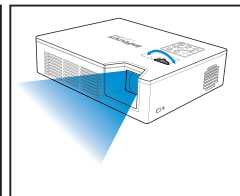
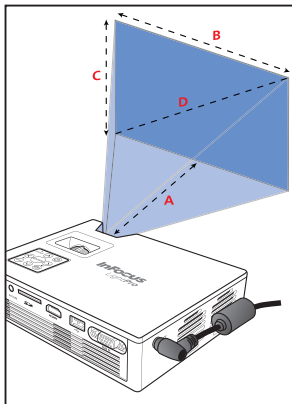

Adjust the focus until the image is clear.

CONNECT INPUT SOURCE - VGA / HDMI

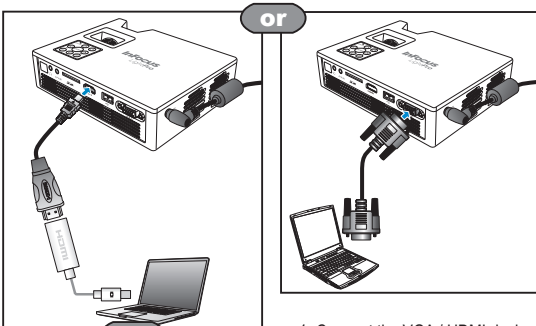

1. Connect the VGA / HDMI device using an appropriate cable.
2. After powering on the projector, press on the control panel or on the remote control to automatically switch the input source.

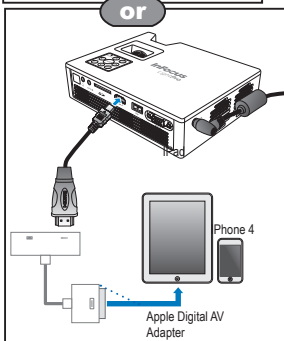

CONNECT INPUT SOURCE - COMPOSITE AV IN

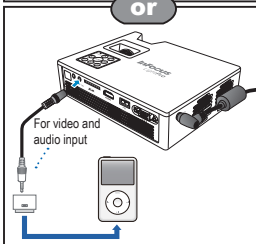
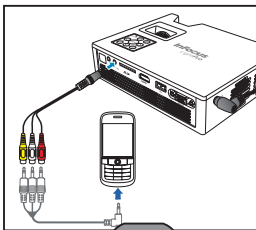

1. Connect the AV input source.
2. After powering on the projector, press on the control panel or on the remote control to automatically switch the input source.

Note

1. All other brand and product names are trademarks or registered trademarks of their respective companies.
2. The cables connecting the video output devices are not supplied, please contact the device vendor.
3. iPod nano/iPod touch/iPhone/iPod classic (version 5 and above)
4. Designed for iPod/iPhone/Mobile phone/PMP with TV out functions. Using with devices with audio signal voltage > 0.3Vrms, is not recommended.
5. Composite mode only supports video input source.

INSERT SD CARD

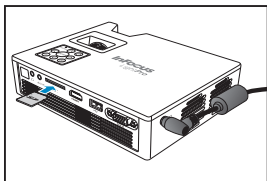

Insert an SD card into the slot with the gold contacts facing down.

Note

- To remove the SD card, simply pull out the memory card from the slot.
- Do not remove the SD card while the projector is projecting images from the card. This can cause data loss or damage the card.
- Supports SD card size up to 32GB.
- The SD card is not included in the package.

INSERT USB FLASH DRIVE

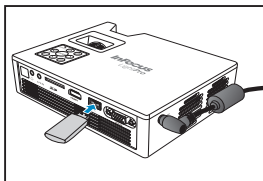

Plug a USB flash drive into the USB connector at the back of projector.

Note

Supports USB flash drive with FAT32 and NTFS formats.

MOUNT THE PROJECTOR

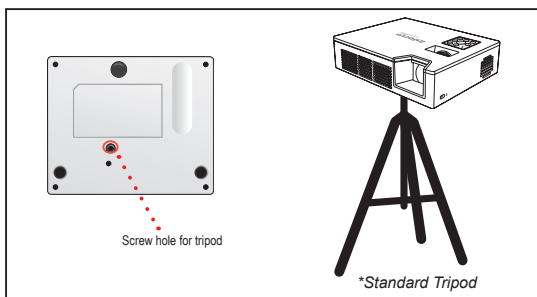

Screw a standard tripod into the screw hole on the projector.

Note

The tripod is an optional accessory.

Remote Control

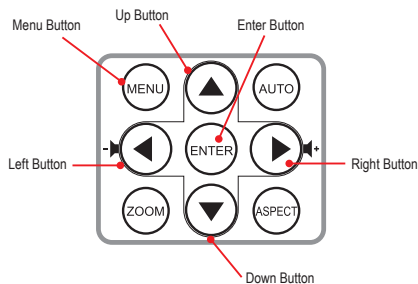

Control Panel

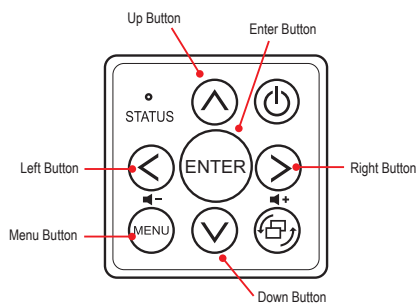

General operation (i.e. using the remote control)

- To enter Home Menu, use the **Auto Source** button to change sources until Multimedia is reached.
- Use ▲/▼ to highlight the desired main menu option and press **ENTER** to confirm the selection.
- To playback media files, press ▲/▼ to select [EZ Media] and press **ENTER** to enter the data source mode. Then press ▲/▼ to select the desired data source and press **ENTER** to enter the EZ Media submenu.
- Buttons functionality varies depending on the current mode.

Home menu



Press ▲/▼ to select the menu item that you want to access and press **ENTER** to enter the menu screen.

Note

A button guide appears on the bottom of most screens. The guide varies depending on the current mode. Press the corresponding button to select the option or operation.

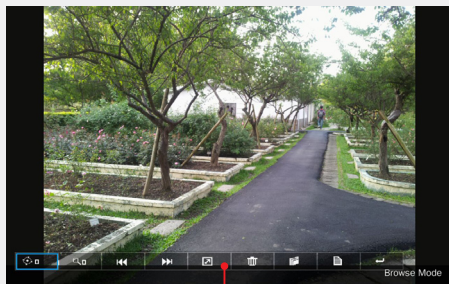

Button Guide

EZ Media submenu

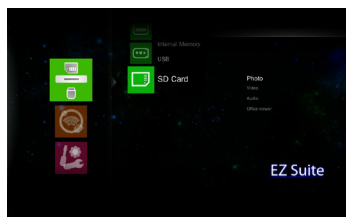
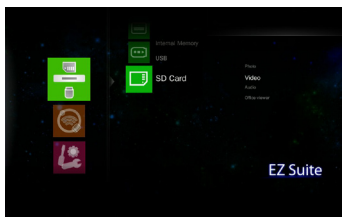
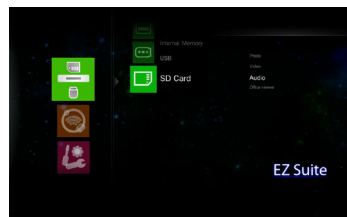

Photo menu



Video menu



Audio menu

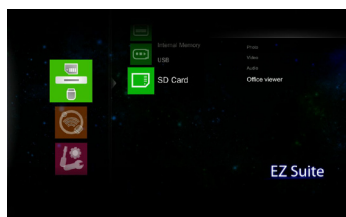

Office viewer menu

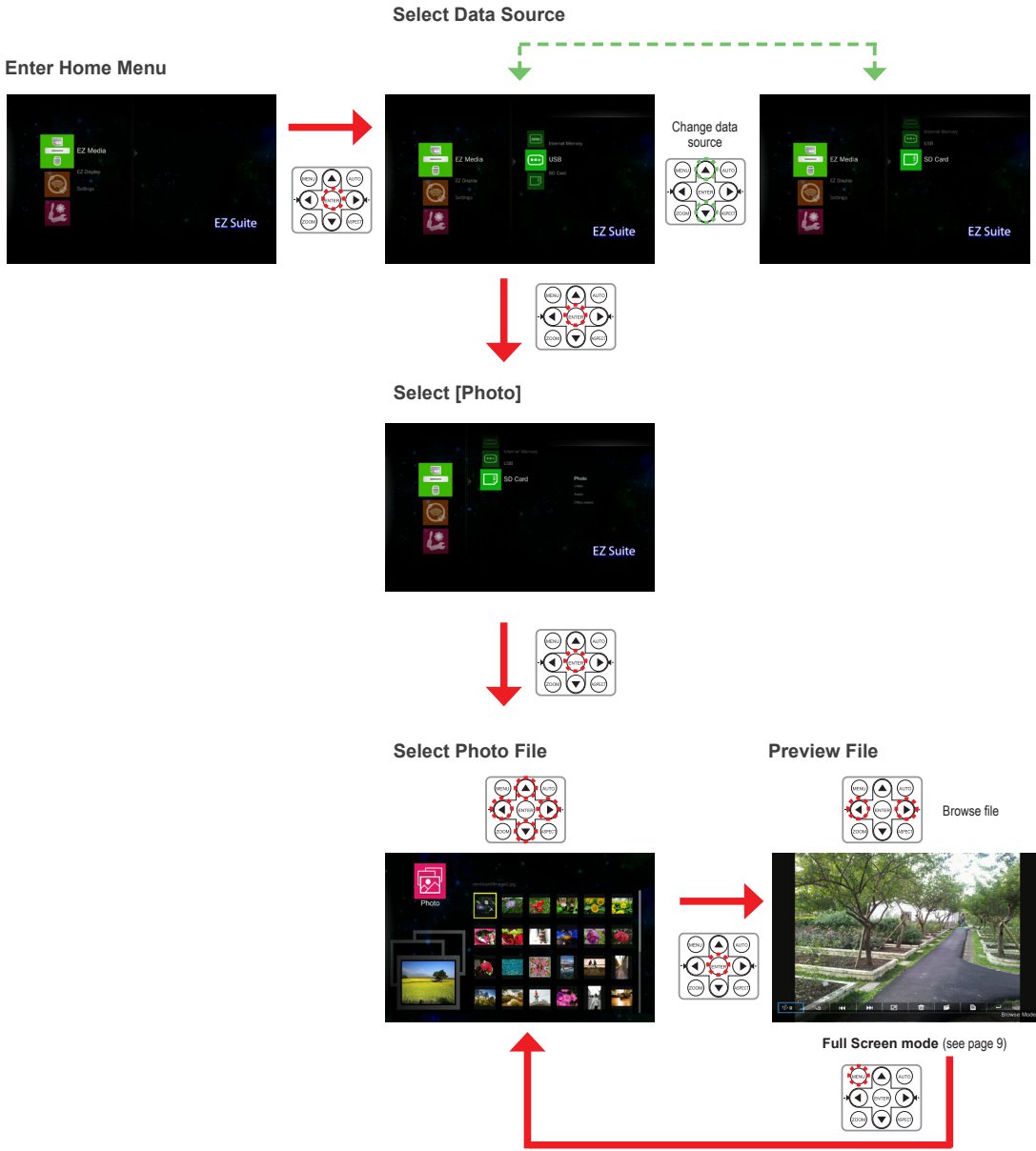

Note
The displayed screen may vary depending on the data source selected in the previous step.

VIEWING PHOTOS - FULL SCREEN DISPLAY

If the slide show function is enabled, photos are played continuously at specified intervals.

- Note
- The button guide disappears when the keypad is not used for 3 seconds. To display the button guide, press any key.
 - To change slideshow settings, see Photo Settings below.
 - Use ◀▶ to navigate between the menu items.
 - Press ENTER to select the menu item.
 - Press MENU to return thumbnail view.

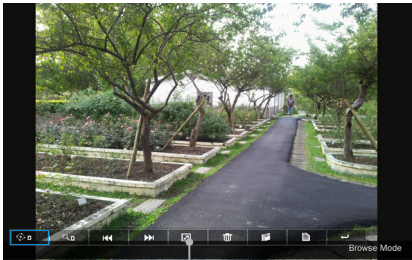

Media Playback Control					
	Rotate photo		Next photo		Copy photo
	Zoom photo		Start Slideshow		Photo properties
	Previous photo		Delete photo		Return to thumbnail display

PHOTO SETTINGS

Enter Home Menu

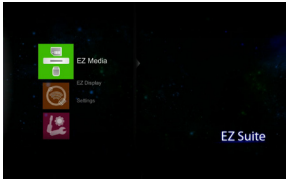

Select [Settings]

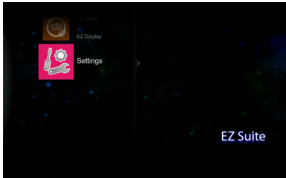

Enter Settings Menu

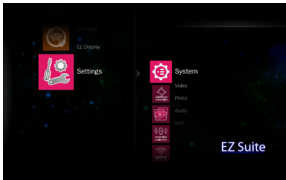

Select [Photo]

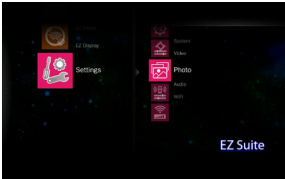

Adjust Settings

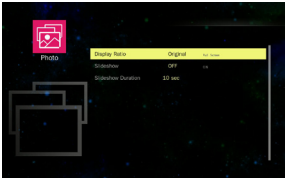



- ▲/▼: Select item
- ◀/▶: Adjust settings

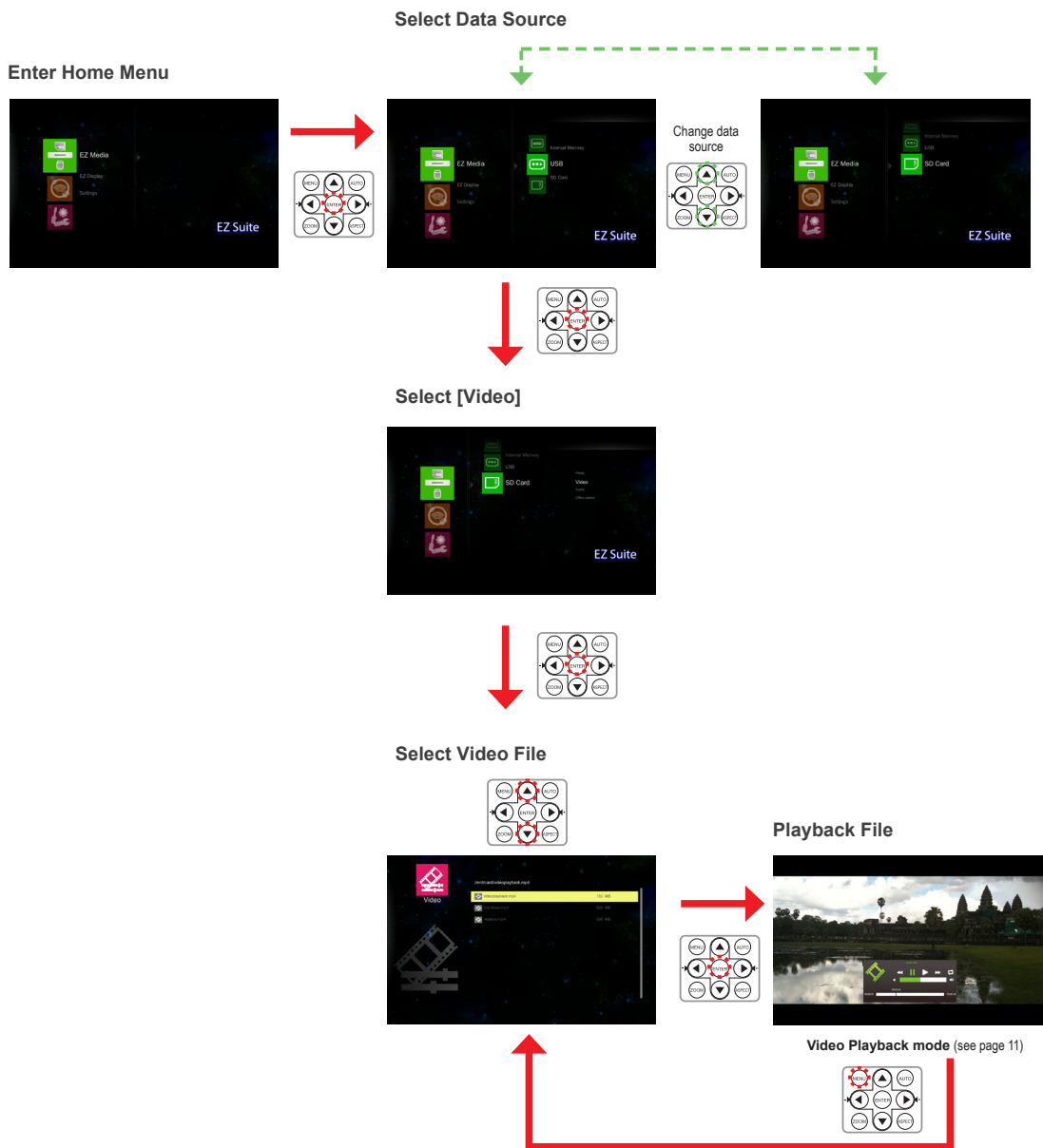



Menu item	Description and Available Options
Display Ratio	Select the aspect ratio of the display. Available options: Fit to screen / Full screen / Crop to screen
Slideshow	Enable/Disable the slide show. Available options: OFF/ ON
Slideshow Duration	Set the interval time between each slide displays. Available options: 10 sec / 30 sec / 1 min

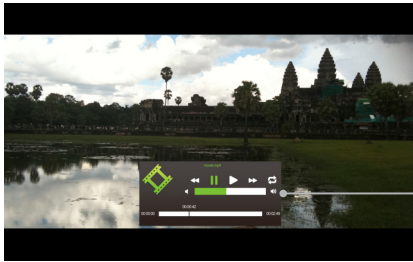

Note
The displayed screen may vary depending on the data source selected in the previous step.

- Note**
- The button guide disappears when the keypad is not used for 3 seconds. To display the button guide, press any key.
 - Use ◀▶ to navigate between the menu items.
 - Press  to select the menu item.
 - Press  to return video file list.



Media Playback Control			
	Rewind		Fast forward
	Pause/Resume/Toggle		Repeat
	Play		

VIDEO SETTINGS

Enter Home Menu

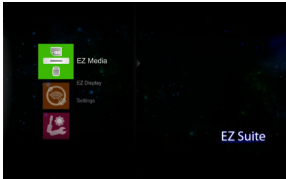

Select [Settings]

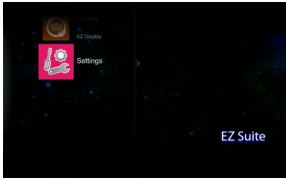

Enter Settings Menu

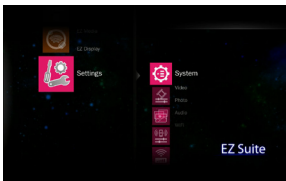

Select [Video]



Adjust Settings

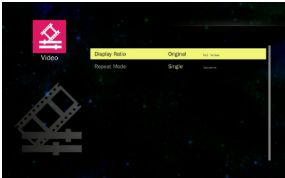

▲▼: Select item
◀▶: Adjust settings

Menu item	Description and Available Options
Display Ratio	Select the aspect ratio of the display. Available options: Original / Full Screen
Repeat Mode	Set video play mode option. Available options: Single / Sequence

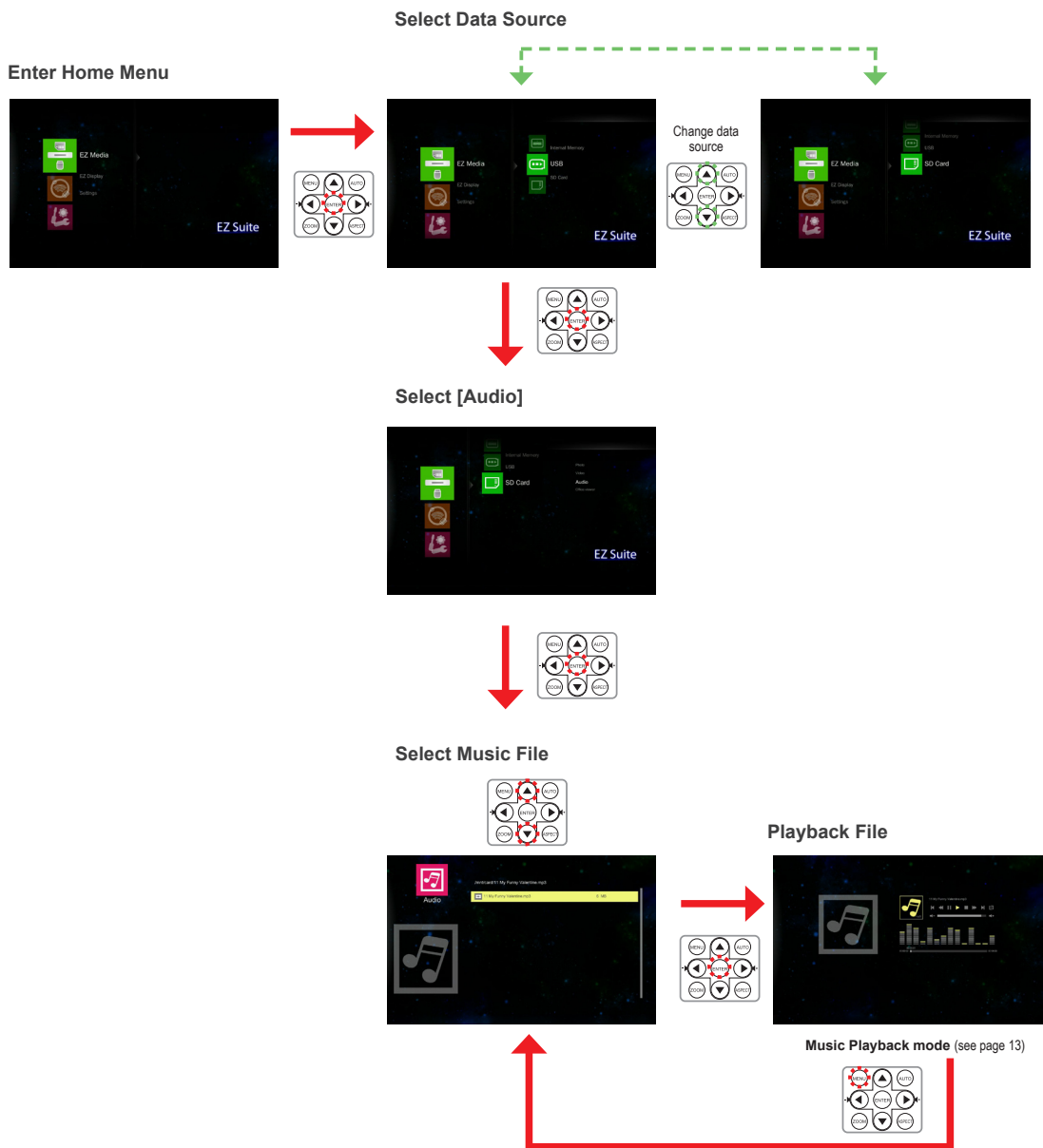

Note

The displayed screen may vary depending on the data source selected in the previous step.

- Note**
- The button guide disappears when the keypad is not used for 3 seconds. To display the button guide, press any key.
 - Use ◀▶ to navigate between the menu items.
 - Press **ENTER** to select the menu item.
 - Press **MENU** to return music file list.

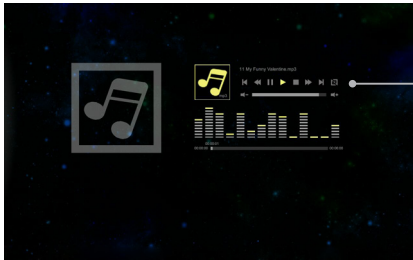

Media Playback Control			
	Previous audio file		Stop
	Rewind		Fast forward
	Pause/resume		Next audio file
	Play		

MUSIC SETTINGS

Enter Home Menu

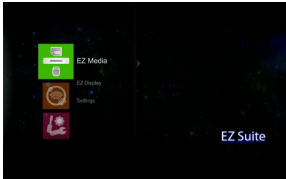

Select [Settings]

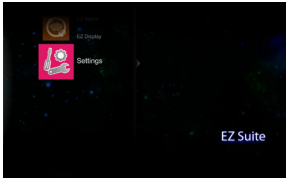

Enter Settings Menu

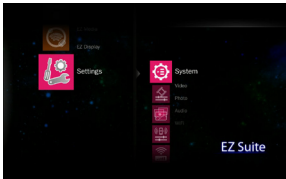

Select [Audio]

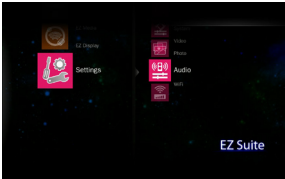

Adjust Settings

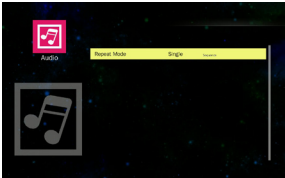

▲/▼: Select item
◀▶: Adjust settings

Menu item	Description and Available Options
Repeat Mode	Set music play mode option. Available options: Single / Sequence

Enter Home Menu

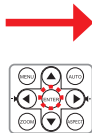

Select Data Source

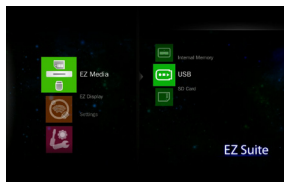

Change data source

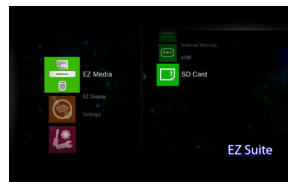

Select [Office viewer]

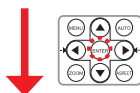
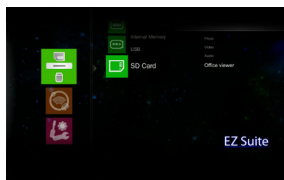

Select File

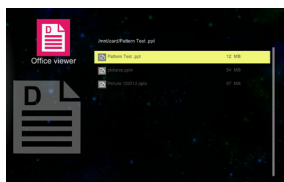

View File

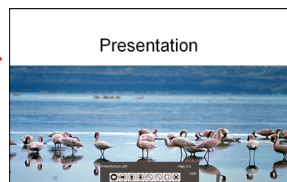
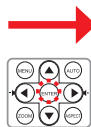



View mode (see page 15)



Note









The displayed screen may vary depending on the data source selected in the previous step.

Note

- The button guide disappears when the keypad is not used for 3 seconds. To display the button guide, press any key.
- Use ◀▶ to navigate between the menu items.
- Press  to select the menu item.
- Press  to return presentation file list.

Full screen view



Media Playback Control			
	Move page left		Zoom in
	Move page right		Zoom out
	Move page up		Fit to screen/height/width
	Move page down		Close the menu

VIEWING SYSTEM SETTINGS

Enter Home Menu

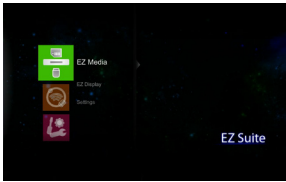

Select [Settings]

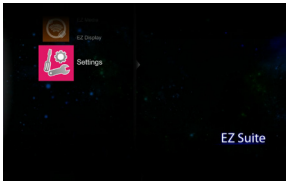

Enter Settings Menu/Select [System]

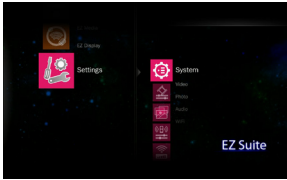

Adjust Settings

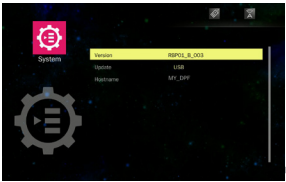

▲/▼: Select item
◀/▶: Adjust settings

Menu item	Description and Available Options
Version	Displays the firmware version.
Update	Allows you to update the firmware of the projector using an SD card or USB thumb drive.
Hostname	Allows you to modify the hostname.

Enter Home Menu



Select [EZ Display]

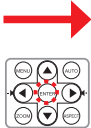
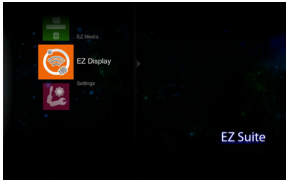

Enter EZ Display Menu

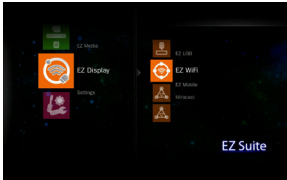

Connect the USB cable

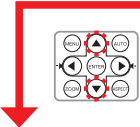
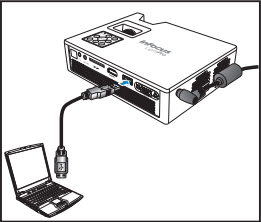

Select [EZ USB]

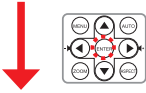
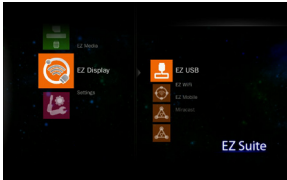

Connect to PC

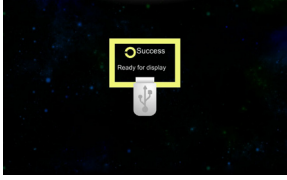

View PC Display



Note
The computer will automatically detect the connection and install the necessary driver.

Wi-Fi DISPLAY

Note

When using Wi-Fi Display function for the first time, download and install the EZ WiFi Display Tool software into your PC:

From the Windows desktop, double-click "Windows OS".
Follow the on-screen instructions to complete the software installation.
IP address: 192.168.111.1



Plug in the Wi-Fi Dongle

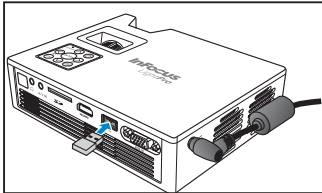

Enter Home Menu

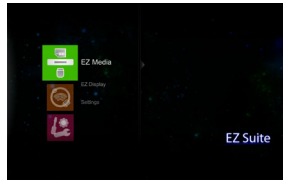

Select [EZ Display]

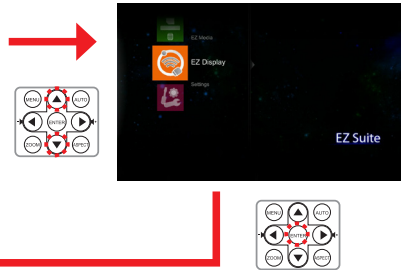

Select [EZ WiFi]

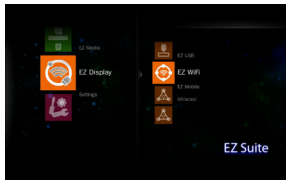

Connect to PC

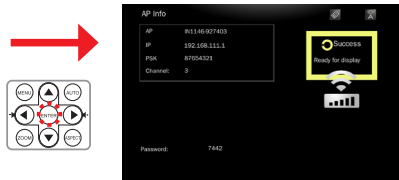

Select the dongle name listed in the Wireless Network Connection list on the PC.

Note

On the initial connection, you will be prompted for the password. Use WPA-PSK with TKIP encryption using the password "12345678", then click **Connect**.

Launch "EZ WiFi" software and view the PC Display

Note

Once connected, the PC will automatically adjust the screen resolution.

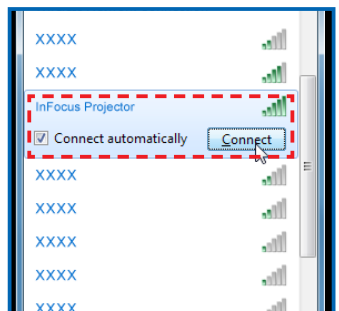
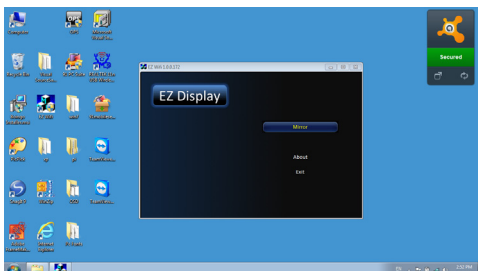

EZ MOBILE DISPLAY (VIA AP MODE)

EZ Mobile allows you to use the media files on your portable device via the DLNA (Digital Living Network Alliance) server

To access the media files stored on your portable device, do the following:

1. In your portable device, download a DLNA compatible Digital Media Server from the App Store (iOS) or Play Store (Android) and open the application.
(For example, "Pixel Media Server - DMS" > tap )
2. Plug the optional Wi-Fi dongle (SP-WIFIUSB-2) into the projector.
3. Enter the Access Point (AP) Mode in projector's menu and set the mode ON (Home Menu > [Settings] > [WiFi] > [AP Mode]).
4. Connect your portable device to the projector's wireless network.

Note

The default access password is **87654321**. The password can be changed on projector's AP Mode menu.

5. Go to projector's Home Menu > [EZ Display] > [EZ Mobile] and wait until the connection is established.

The media files on your portable device can be accessed using the projector.

Plug in the Wi-Fi Dongle

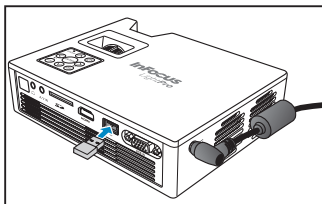

Enter Home Menu

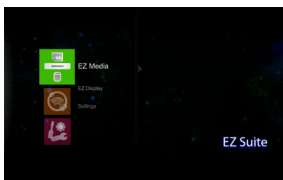

Select [Settings]

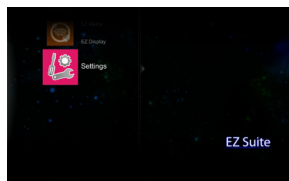

Select [WiFi]

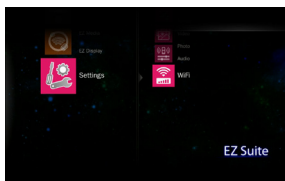

Enter [AP Mode]

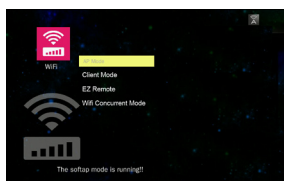

Select [ON]

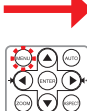
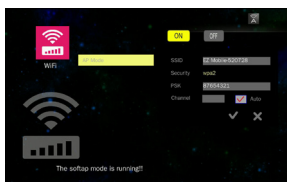

Enter [EZ Display]

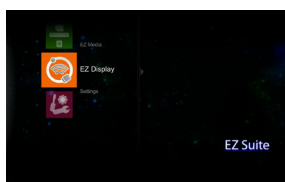

Enter [EZ Mobile]

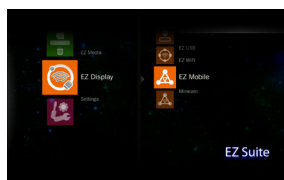

Connect to DLNA Server

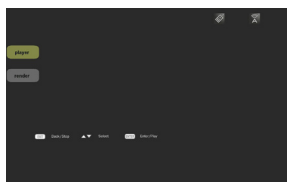

EZ MOBILE DISPLAY (VIA CLIENT MODE)

To access the media files stored on your portable device, do the following:

1. In your portable device, download a DLNA compatible Digital Media Server from the App Store (iOS) or Play Store (Android) and open the application.
(For example, "Pixel Media Server - DMS" > tap )
 2. Plug the optional Wi-Fi dongle (SP-WIFIUSB-2) into the projector.
 3. Enter the Client Mode in the projector's menu and set the mode ON (Home Menu > [Settings] > [WiFi] > [Client Mode]).
 4. Connect the projector to a Wi-Fi Access Point.
 5. Connect your portable device to the same Wi-Fi Access Point with your projector.
 6. Go to projector's Home Menu > [EZ Display] > [EZ Mobile] and wait until the connection is established.
- The media files on your portable device can be accessed using the projector.

Plug in the Wi-Fi Dongle

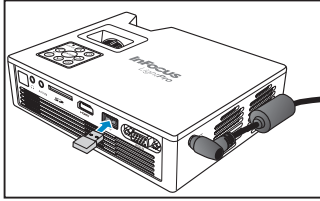

Enter Home Menu

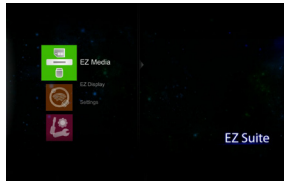

Select [Settings]

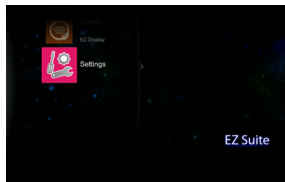

Select [WiFi]

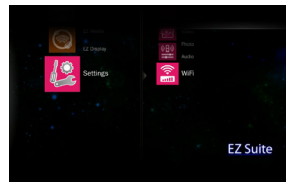

Enter [Client Mode]

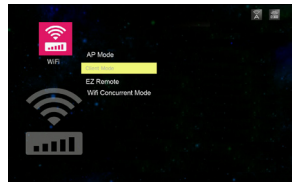

Select [ON]

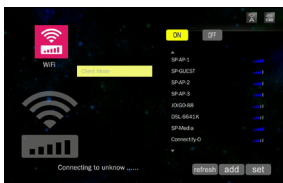

Enter [EZ Display]

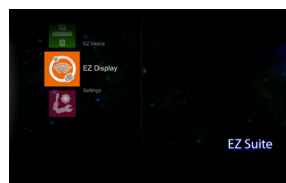

Enter [EZ Mobile]

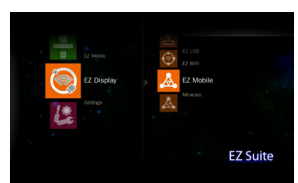

Connect to DLNA Server

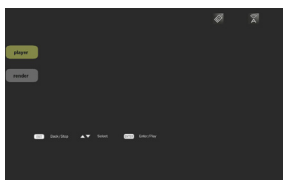

MIRACAST DISPLAY

Use Miracast to view peer-to-peer wireless screencast.

To start using Miracast, do the following:

1. In your portable device, download a peer-to-peer screencast application from the App Store (iOS) or Play Store (Android). (For example, "MirrorOp Sender".)
2. Plug the optional Wi-Fi dongle (SP-WIFIUSB-2) into the projector.
3. Open a peer-to-peer screencast application on your portable device. (For example, tap ).
4. Enter Miracast in the projector's menu and wait until the connection to the portable device is established. (Home Menu > [EZ Display] > [Miracast]).

Plug in the Wi-Fi Dongle

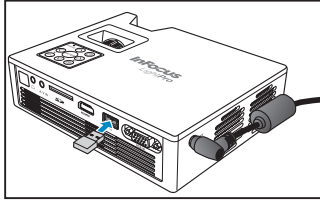

Enter Home Menu

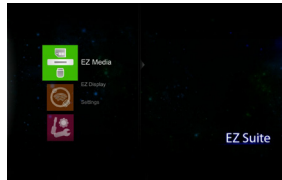

Enter [EZ Display]

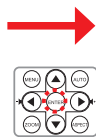
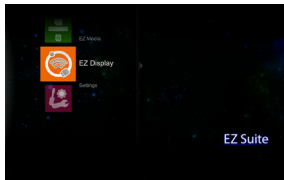

Enter [Miracast]

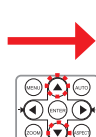
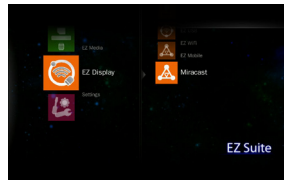

Miracast

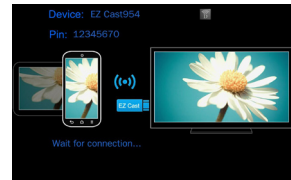

EZ REMOTE DISPLAY

EZ Remote allows you to remotely control the projector on your portable device wirelessly.

To setup remote control, do the following:

1. In your portable device, download the "EZ Remote" application from the App Store (iOS) or Play Store (Android).
2. Plug the optional Wi-Fi dongle (SP-WIFIUSB-2) into the projector.
3. Enter the Client Mode in the projector's menu and set the mode ON (Home Menu > [Settings] > [WiFi] > [Client Mode]).
4. Connect the projector to a Wi-Fi Access Point.
5. Enter EZ Remote mode in projector's menu and enable the mode (Home Menu > [Settings] > [WiFi] > [EZ Remote]).

Plug in the Wi-Fi Dongle

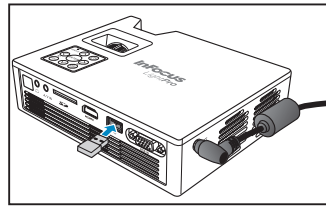

Enter Home Menu

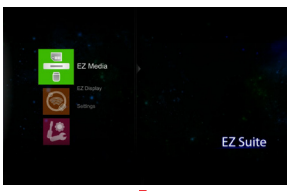

Select [Settings]

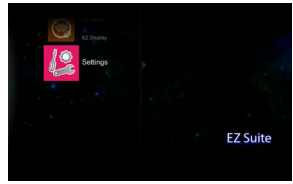

Select [WiFi]

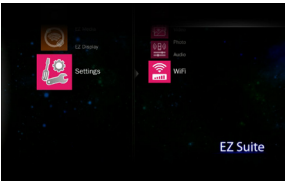

Enter [AP Mode]

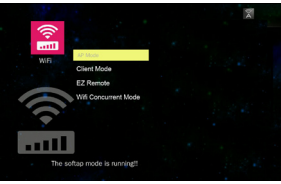

Select [ON]



Select [EZ Remote]

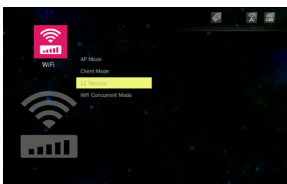

Select [ON]

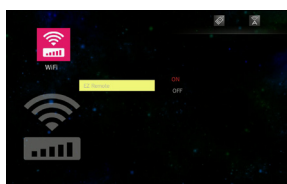

6. Connect your portable device to the same Wi-Fi Access Point with your projector.
7. Tap to open "EZ Remote" and pair projector with your portable device.
8. In your portable device, use the on-screen navigation buttons to control your projector.

Select [Projector]



Use Navigation Buttons



WiFi CONCURRENT MODE DISPLAY

Use WiFi Concurrent Mode to view and modify the software and Client Mode Access Point settings.

Plug in the Wi-Fi Dongle

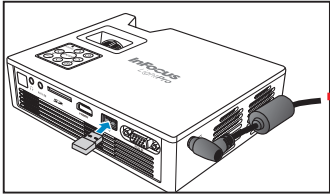

Enter Home Menu

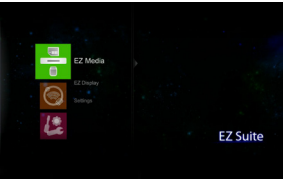

Select [Settings]

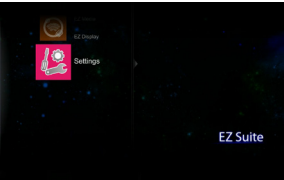

Select [WiFi]

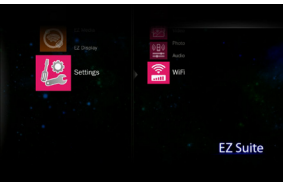

Select [Wifi Concurrent Mode]

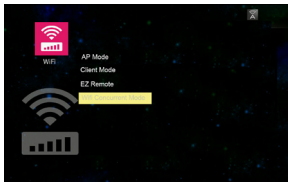

Preview/Modify AP Settings

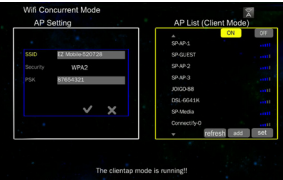

ADJUST MENU SETTINGS FOR EXTERNAL INPUT SOURCE

Selecting Input Source

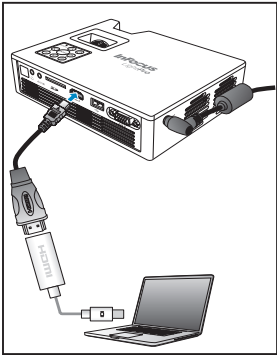

Once a video source device is connected and turned on, press on the remote control or on the control panel to automatically switch the input source.

Available sources are in the following order:

1. VGA
2. HDMI
3. Component
4. Composite
5. Multimedia

Note: The start position in the list is determined by the last connected input source.

Entering Menu Mode

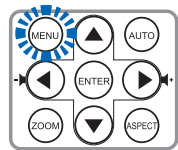

Press on the remote control or MENU on the control panel to enter the menu mode.



Menu Operation			
▲	Select main menu	▶	Enter current submenu
▼			Hide OSD menu
Submenu Operation			
▲	Move up	◀	Adjust setting
▼	Move down	▶	

Menu Items

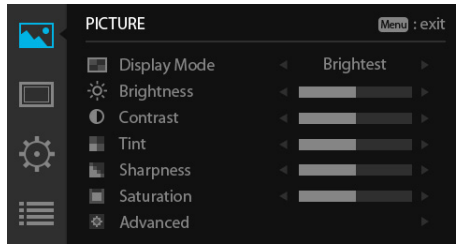

PICTURE menu

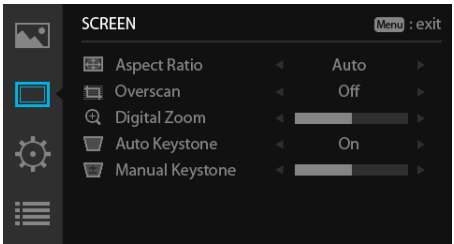

SCREEN menu

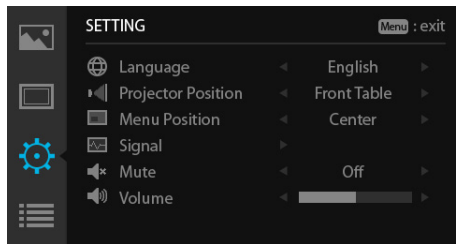

SETTING menu

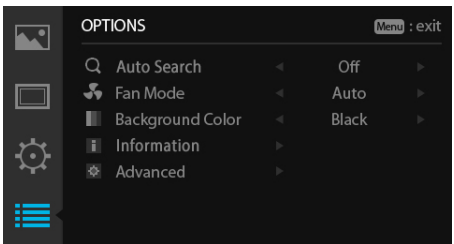

OPTIONS menu

Refer to the below table for details on menu items.

Menu	Menu item	Description
PICTURE	Display Mode	Set the brightness of the display.
	Brightness	Adjust the brightness of the image.
	Contrast	Adjust the contrast of the image.
	Tint	Adjust the balance of the red, green, and blue colors of the image.
	Sharpness	Adjust the sharpness or softness of the image.
	Saturation	Adjust the color intensity.
	Advanced	Set advanced settings for projected image.
		Gamma Adjust the color gamma differences between the dark and bright portions of the input signal.
		BrilliantColor Increase the brightness by changing the colors.
		Color Temperature Select the color temperature in the display.
		Color Space Adjust the color for projected image from a video input signal.
SCREEN	Exit	Return to the PICTURE submenu.
	Aspect Ratio	Select the aspect ratio of the display.
	Overscan	Enable overscan display (only for HDMI input signal).
	Digital Zoom	Digitally enlarge the projected image.
	Auto Keystone	Automatically adjust the trapezoidal (keystone) distortion of the projected image.
SETTING	Manual Keystone	Manually adjust the trapezoidal (keystone) distortion of the projected image.
	Language	Set the on-screen display language.
	Projector Position	Select the projector position.
	Menu Position	Set the display position of the OSD menu.
	Signal	Adjust the PC display settings.
		Auto Synchronize the display automatically.
		Phase Adjust to reduce horizontal noise.
		Clock Adjust to reduce vertical noise.
		H Position Move the screen position horizontally.
		V Position Move the screen position vertically.
		Exit Return to the SETTING submenu.
	Mute	Temporarily turn off the sound.
	Volume	Adjust the volume of the built-in speaker.
	Auto Search	Automatically detects the input signal when the projector is turned on.
	Fan Mode	Set the fan speed according to altitude.
OPTIONS	Background Color	Set the background screen color when there is no input signal.
	Information	Display the projector information.
	Advanced	Configure other general settings.
		Direct Power On Turn on the projector power automatically when the power supply is switched on.
		Auto Power Off Set the projector to automatically turn off if it is left idle at the preset time.
		Reset All Settings Reset all settings to the factory default settings.
	Exit	Return to the OPTIONS submenu.

MEDIA FILE SUPPORT LIST

Video

File Type	Video	Resolution	Bit Rate	Frame Rate	Audio Code	Remark
AVI MKV	XVID MPEG4 H.264 M-JPEG WMV3	1080P	20Mbps	30fps	AC3 DTS MPEG1/2/3 PCM ADPCM AAC	No support VC-1 AP H.264 support less than 4 reference frames
TS	H.264	1080P	20Mbps	30fps	AC3 AAC MPEG1/2/3 DTS LPCM	H.264 support less than 4 reference frames
DAT VOB MPG MPEG	MPEG-1	1080P	20Mbps	30fps	MPEG1/2/3 AC3 DTS LPCM	
MOV MP4 3GP	MPEG-4 H.264 H.263	1080P	20Mbps	30fps	AAC AMR PCM ADPCM	H.264 support less than 4 reference frames
RM RMVB	RV3 RV4	720P	5Mbps	30fps	Cook(RA4) AAC(RA9) RAC(PA10)	
WMV	WMV3	1080P	20Mbps	30fps	WMA2 WMA3	No support VC-1 AP

Photo

Image Type (Ext name)	Sub Type	Encode Type	Max Pixels
JPEG JPG	Baseline	YUV400	No Limit
		YUV420	No Limit
		YUV422	No Limit
		YUV440	No Limit
		YUV444	No Limit
	Progressive	YUV400	Width<=10240 & Height <= 6400
		YUV420	
		YUV422	
		YUV440	
BMP			No Limit

Document

Supported Versions	Microsoft® Office Application	File Extension
Microsoft® Office 95	Word	.doc
Microsoft® Office 97		.docx
Microsoft® Office 2000	Power Point	.ppt
Microsoft® Office 2003	Excel	.pptx
Microsoft® Office 2007		.xls
Microsoft® Office 2010	Adobe PDF	.xlsx
		.pdf

Music

Music Type (Ext name)	Sample Rate (KHz)	Bit Rate (Kbps)
MP1/MP2/MP3	8-48	8-320
WMA	22-48	5-320
OGG	8-48	64-320
ADPCM-WAV	8-48	32-384
PCM-WAV	8-48	128-1536
AAC	8-48	8-256

SPECIFICATIONS

Item	Description
Model	IN1146
Imager	DMD WXGA 0.45"
Native Resolution	1280x800 WXGA
Projection Distance	0.9-2.4 m (2ft 11in to 7ft 10in)
Projection Screen Size	20"-150" (0.5m to 3.81m)
Focus	Manual
Throw Ratio	1.4
Vertical Keystone	±40°
Projection Modes	Table Top, Front Projection/Rear Projection
Standard Input Resolutions	up to SXGA+ (60Hz)
SDTV/EDTV/HDTV	480i, 480p, 576i, 567p, 720p, 1080i
Video Signal	NTSC/ NTSC4.43/ PAL (Including PAL-M, PAL-N)/SECAM/ PAL60"
Horizontal Frequency	30.5 - 91.1kHz
Vertical Frequency	50 - 85Hz
Safety Certifications	CE, CB, FCC
Operating Temperature	0 - 40°C
Dimensions (WxHxD)	175 x 44.5 x 138mm
Power Input	AC adapter 100~240 V, 50Hz/60Hz
Power Consumption	Typical 85W@110Vac
Standby	<0.5W
Lamp	LED
Lamp Life	20,000 Hours
Speakers	2Wx2
Input Ports	VGA (15 pin D-sub)
	HDMI
	A/V In 3.5mm
	USB
Security	SD card
	Kensington Slot

TROUBLESHOOTING

If you experience a problem with your projector, please refer to the following information. If a problem persists, please contact your local retailer or service center.

Image Problems

☆ **No image appears on-screen**

- Ensure the power cord is correctly and securely connected.
- Ensure the pins of connectors are not crooked or broken.
- Make sure the projector is switched on.

☆ **Image is out of focus**

- Adjust the Focus Dial.
- Make sure the projection screen is between the required distance 0.9 to 2.4 meters (2ft 11in to 7ft 10in) from the projector. See page 5.

☆ **Image is too small or too large**

- Move the projector closer to or further from the screen.

Audio Problems

☆ **No sound**

- During music playback, press ◀▶ on the remote control or </> on the control panel.

Note

When the projector temperature reaches 85°C, the projector automatically shuts down due to the built-in temperature protection. This is not a malfunction. Let the projector cool down before switching it on again.