

**Kramer Electronics, Ltd.**



# **USER MANUAL**

**Model:**

**VP-222K**

*UXGA Switcher / DA*

## Contents

<b>1</b>	<b>Introduction</b>	<b>1</b>
<b>2</b>	<b>Getting Started</b>	<b>1</b>
2.1	Quick Start	2
<b>3</b>	<b>Overview</b>	<b>3</b>
<b>4</b>	<b>Your UXGA Switcher / DA</b>	<b>4</b>
<b>5</b>	<b>Connecting the UXGA Switcher / DA</b>	<b>5</b>
<b>6</b>	<b>Technical Specifications</b>	<b>6</b>

## Figures

Figure 1: VP-222K UXGA Switcher / DA	4
Figure 2: VP-222K UXGA Switcher / DA Connections	5

## Tables

Table 1: Features and Functions of the VP-222K UXGA Switcher / DA	4
Table 2: Technical Specifications of the VP-222K UXGA Switcher / DA	6

## 1 Introduction

Welcome to Kramer Electronics! Since 1981, Kramer Electronics has been providing a world of unique, creative, and affordable solutions to the vast range of problems that confront the video, audio, presentation, and broadcasting professional on a daily basis. In recent years, we have redesigned and upgraded most of our line, making the best even better! Our 1,000-plus different models now appear in 11 groups<sup>1</sup> that are clearly defined by function.

Thank you for purchasing your Kramer TOOLS **VP-222K UXGA Switcher / DA**, which is ideal for computer and presentation VGA/XGA routing and distribution.

The package includes the following items:

- **VP-222K UXGA Switcher / DA**
- Power adapter (5V DC input)
- This user manual<sup>2</sup>

## 2 Getting Started

We recommend that you:

- Unpack the equipment carefully and save the original box and packaging materials for possible future shipment
- Review the contents of this user manual
- Use Kramer high-performance high-resolution cables<sup>3</sup>

---

1 GROUP 1: Distribution Amplifiers; GROUP 2: Switchers and Matrix Switchers; GROUP 3: Control Systems; GROUP 4: Format/Standards Converters; GROUP 5: Range Extenders and Repeaters; GROUP 6: Specialty AV Products; GROUP 7: Scan Converters and Scalers; GROUP 8: Cables and Connectors; GROUP 9: Room Connectivity; GROUP 10: Accessories and Rack Adapters; GROUP 11: Sierra Products

2 Download up-to-date Kramer user manuals from our Web site at <http://www.kramerelectronics.com>

3 The complete list of Kramer cables is on our Web site at <http://www.kramerelectronics.com>

## 2.1 Quick Start

This quick start chart summarizes the basic setup and operation steps.

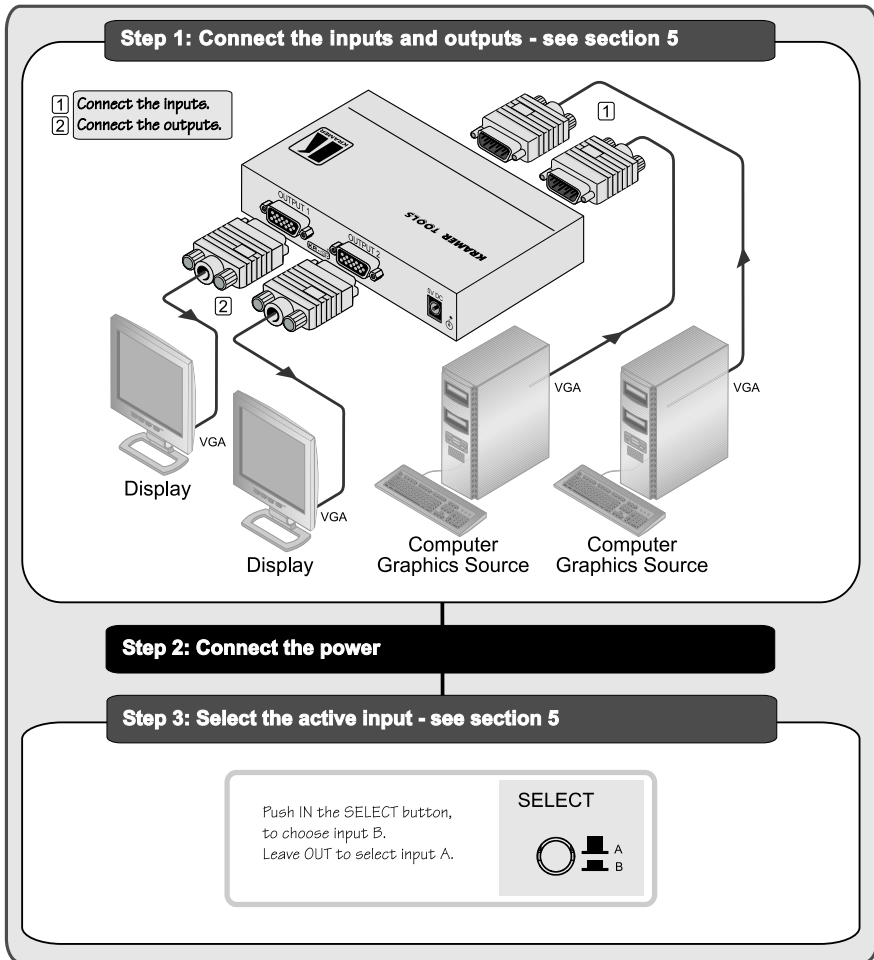

### 3 Overview

Your **VP-222K UXGA Switcher / DA** is a combined 2x1 switcher and 1:2 distribution amplifier for computer graphics signals. The **VP-222K UXGA Switcher / DA** has two inputs and a switch to select between the two sources.

More specifically, the **VP-222K UXGA Switcher / DA** features:

- A video bandwidth of 415MHz that ensures transparent operation at the highest resolution UXGA modes
- Buffered and isolated inputs that are distributed to two identical outputs, allowing different acceptors to be connected (monitors, projectors)
- KR-ISP™ advanced sync processing that ensures compatibility with a wide range of computers (even if the sync level is low) by restoring the sync signal waveform

To achieve the best performance:

- Use only good quality connection cables<sup>1</sup> to avoid interference, deterioration in signal quality due to poor matching, and elevated noise levels (often associated with low quality cables).
- Avoid interference from neighboring electrical appliances that may adversely influence signal quality and position your Kramer **VP-222K** away from moisture, excessive sunlight and dust



**Caution** – No operator-serviceable parts inside unit.

**Warning** – Use only the Kramer Electronics input power wall adapter that is provided with this unit<sup>2</sup>.

**Warning** – Disconnect power and unplug unit from wall before installing or removing device or servicing unit.

<sup>1</sup> Available from Kramer Electronics on our Web site at <http://www.kramerelectronics.com>

<sup>2</sup> For example, part number 2535-052002

# 4 Your UXGA Switcher / DA

Figure 1 and Table 1 define the **VP-222K UXGA Switcher / DA**:

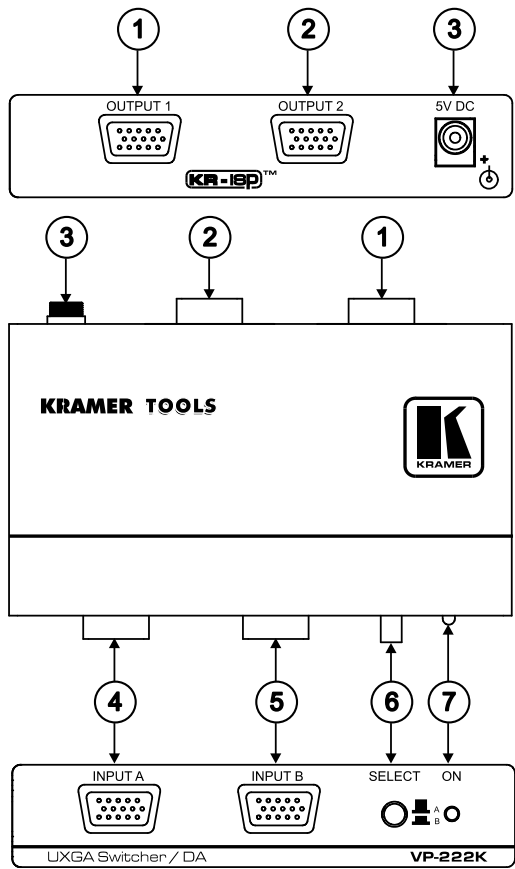

Figure 1: VP-222K UXGA Switcher / DA

Table 1: Features and Functions of the VP-222K UXGA Switcher / DA

#	Feature	Function
1	OUTPUT 1 15-pin HD (F) connector	Connects to the UXGA acceptor 1
2	OUTPUT 2 15-pin HD (F) connector	Connects to the UXGA acceptor 2
3	5V DC	+5V DC connector for powering the unit
4	INPUT A 15-pin HD (F) connector	Connects to the UXGA source A
5	INPUT B 15-pin HD (F) connector	Connects to the UXGA source B
6	A/B Button	Releasing selects INPUT A; pushing in selects INPUT B
7	ON LED	Illuminates when receiving power

## 5 Connecting the UXGA Switcher / DA

To use your **VP-222K UXGA Switcher / DA**, as illustrated in *Figure 2*, do the following:

1. Connect the **OUTPUT 1 15-pin HD (F)** connector to the acceptor 1 (for example, a display) and the **OUTPUT 2 15-pin HD (F)** connector to the acceptor 2.
2. Connect the source A (for example, a PC) to the **INPUT A 15-pin HD (F)** connector and the source B to the **INPUT B 15-pin HD (F)** connector.
3. Connect the 5V DC power adapter to the power socket and connect the adapter to the mains electricity.
4. Set the A/B button, as follows:
  - Release the A/B button to route the **INPUT A** signal via the **OUTPUT 1** connector to the acceptor 1 and via the **OUTPUT 2** connector to the acceptor 2, simultaneously
  - Push in the A/B button to route the **INPUT B** signal via the **OUTPUT 1** connector to the acceptor 1 and via the **OUTPUT 2** connector to the acceptor 2, simultaneously

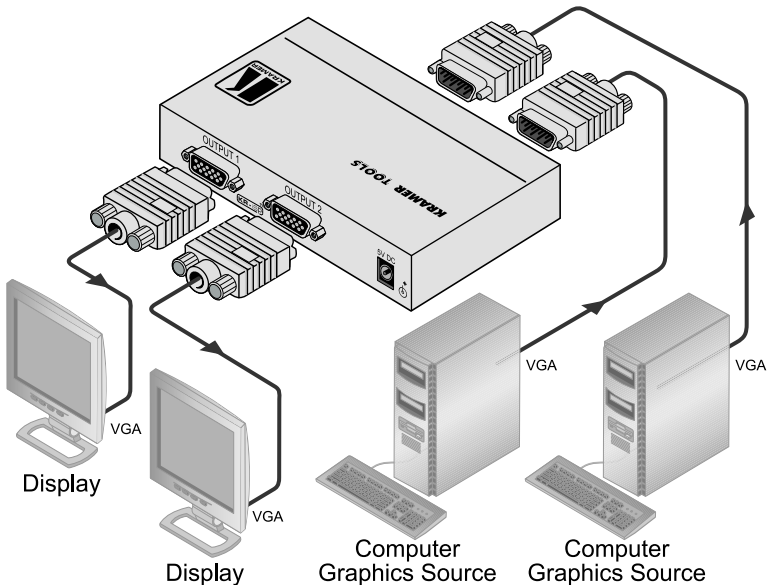

*Figure 2: VP-222K UXGA Switcher / DA Connections*

## 6 Technical Specifications

The **VP-222K** technical specifications are shown in *Table 2*:

*Table 2: Technical Specifications<sup>1</sup> of the VP-222K UXGA Switcher / DA*

INPUTS:	2 UXGA on 15-pin HD connectors
OUTPUTS:	2 UXGA on 15-pin HD connectors
VIDEO BANDWIDTH (-3dB):	415MHz
DIFF. GAIN:	<0.02%
DIFF. PHASE:	<0.02Deg
VIDEO S/N RATIO:	73dB
K-FACTOR:	<0.05%
CROSSTALK:	-58dB @5MHz
DIMENSIONS:	12cm x 7.0cm x 2.5cm (4.7" x 2.8" x 1.0") W, D, H
POWER SOURCE:	5V DC, 115mA
WEIGHT:	0.26kg (0.58lbs) approx.
ACCESSORIES:	Power supply, mounting bracket
OPTIONS:	19" rack adapter

<sup>1</sup> Specifications are subject to change without notice



---

## LIMITED WARRANTY

Kramer Electronics (hereafter *Kramer*) warrants this product free from defects in material and workmanship under the following terms.

### HOW LONG IS THE WARRANTY

Labor and parts are warranted for seven years from the date of the first customer purchase.

### WHO IS PROTECTED?

Only the first purchase customer may enforce this warranty.

### WHAT IS COVERED AND WHAT IS NOT COVERED

Except as below, this warranty covers all defects in material or workmanship in this product. The following are not covered by the warranty:

1. Any product which is not distributed by Kramer, or which is not purchased from an authorized Kramer dealer. If you are uncertain as to whether a dealer is authorized, please contact Kramer at one of the agents listed in the Web site [www.kramerelectronics.com](http://www.kramerelectronics.com).
2. Any product, on which the serial number has been defaced, modified or removed, or on which the WARRANTY VOID IF TAMPERED sticker has been torn, reattached, removed or otherwise interfered with.
3. Damage, deterioration or malfunction resulting from:
  - i) Accident, misuse, abuse, neglect, fire, water, lightning or other acts of nature
  - ii) Product modification, or failure to follow instructions supplied with the product
  - iii) Repair or attempted repair by anyone not authorized by Kramer
  - iv) Any shipment of the product (claims must be presented to the carrier)
  - v) Removal or installation of the product
  - vi) Any other cause, which does not relate to a product defect
  - vii) Cartons, equipment enclosures, cables or accessories used in conjunction with the product

### WHAT WE WILL PAY FOR AND WHAT WE WILL NOT PAY FOR

We will pay labor and material expenses for covered items. We will not pay for the following:

1. Removal or installations charges.
2. Costs of initial technical adjustments (set-up), including adjustment of user controls or programming. These costs are the responsibility of the Kramer dealer from whom the product was purchased.
3. Shipping charges.

### HOW YOU CAN GET WARRANTY SERVICE

1. To obtain service on your product, you must take or ship it prepaid to any authorized Kramer service center.
2. Whenever warranty service is required, the original dated invoice (or a copy) must be presented as proof of warranty coverage, and should be included in any shipment of the product. Please also include in any mailing a contact name, company, address, and a description of the problem(s).
3. For the name of the nearest Kramer authorized service center, consult your authorized dealer.

### LIMITATION OF IMPLIED WARRANTIES

All implied warranties, including warranties of merchantability and fitness for a particular purpose, are limited in duration to the length of this warranty.

### EXCLUSION OF DAMAGES

The liability of Kramer for any effective products is limited to the repair or replacement of the product at our option. Kramer shall not be liable for:

1. Damage to other property caused by defects in this product, damages based upon inconvenience, loss of use of the product, loss of time, commercial loss; or:
2. Any other damages, whether incidental, consequential or otherwise. Some countries may not allow limitations on how long an implied warranty lasts and/or do not allow the exclusion or limitation of incidental or consequential damages, so the above limitations and exclusions may not apply to you.

This warranty gives you specific legal rights, and you may also have other rights, which vary from place to place.

**NOTE:** All products returned to Kramer for service must have prior approval. This may be obtained from your dealer.

This equipment has been tested to determine compliance with the requirements of:

- EN-50081: "Electromagnetic compatibility (EMC);  
generic emission standard.  
Part 1: Residential, commercial and light industry"
- EN-50082: "Electromagnetic compatibility (EMC) generic immunity standard.  
Part 1: Residential, commercial and light industry environment".
- CFR-47: FCC\* Rules and Regulations:  
Part 15: "Radio frequency devices  
Subpart B Unintentional radiators"

### CAUTION!

- ☒ Servicing the machines can only be done by an authorized Kramer technician. Any user who makes changes or modifications to the unit without the expressed approval of the manufacturer will void user authority to operate the equipment.
- ☒ Use the supplied DC power supply to feed power to the machine.
- ☒ Please use recommended interconnection cables to connect the machine to other components.  
\* FCC and CE approved using STP cable (for twisted pair products)

---

**For the latest information on our products and a list of Kramer distributors, visit our Web site: [www.kramerelectronics.com](http://www.kramerelectronics.com) where updates to this user manual may be found.**  
**We welcome your questions, comments and feedback.**



**Caution**

**Safety Warning:**

Disconnect the unit from the power supply before opening/servicing.



---

**Kramer Electronics, Ltd.**

Web site: [www.kramerelectronics.com](http://www.kramerelectronics.com)

E-mail: [info@kramerel.com](mailto:info@kramerel.com)

**P/N: 2900-000481 REV 1**