



V-8HD Remote is a dedicated iPad application for the Roland V-8HD. Connecting the V-8HD and the iPad via USB lets you operate the V-8HD from V-8HD Remote.

\* V-8HD Remote can be used with V-8HD units that are running version 1.03 or later. Be sure to update your V-8HD unit to the latest version.

## Connecting the iPad and the V-8HD

### 1. Connect the V-8HD's USB port to the iPad.

Using a commercially available connection or an adaptor cable (Lightning-USB camera adaptor), connect the unit to the iPad.

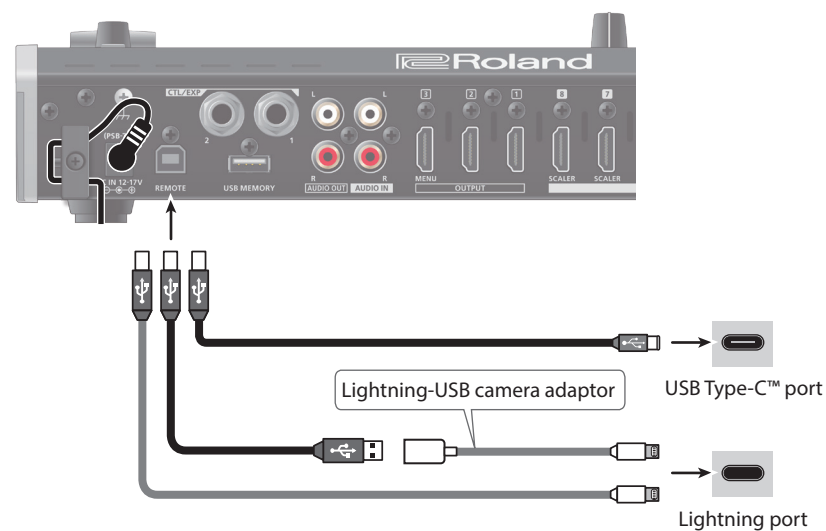

### 2. Turn on the power to the V-8HD.

## Starting and Quitting V-8HD Remote

### Starting the V-8HD Remote

1. Turn on the power to the iPad on which V-8HD Remote is installed.
2. Tap the V-8HD Remote icon.



V-8HD Remote starts, and the V-8HD Remote screen appears.

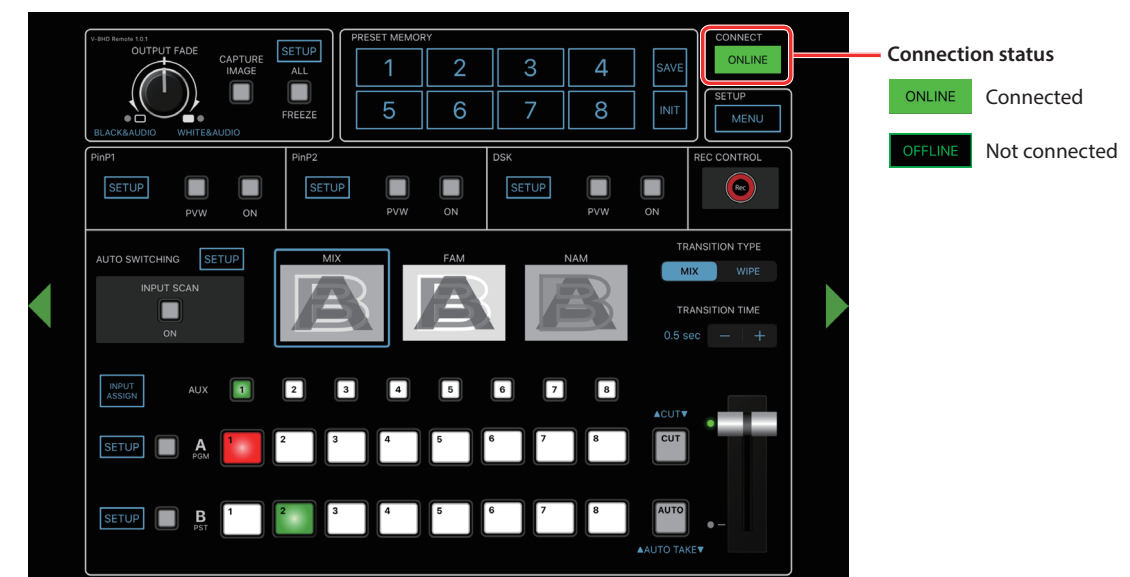

### NOTE

If the connection status does not change to "ONLINE" (connected), re-check the connection between the iPad and the V-8HD unit.

### Quitting

#### 1. Press the Home button on the iPad.

V-8HD Remote ends, and the Home screen reappears.

Part Names and Functions

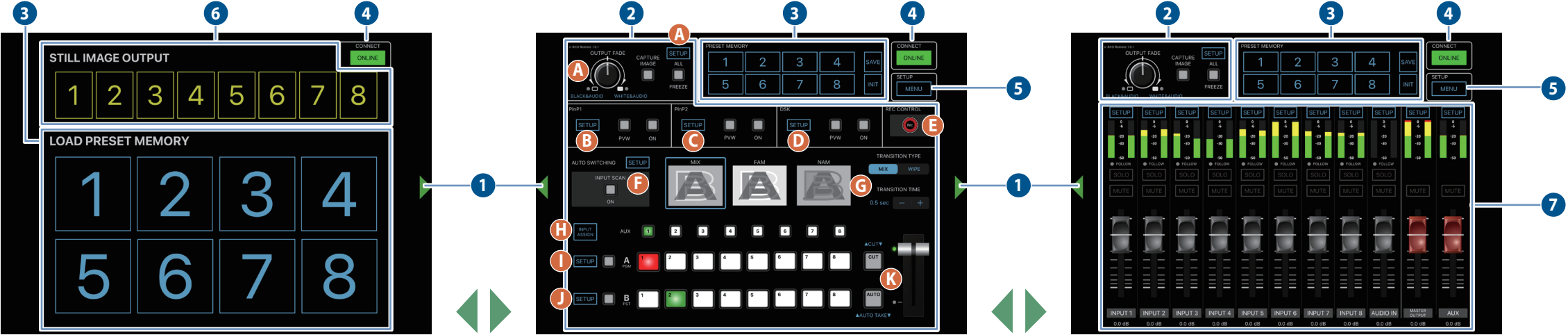

For more details on setting items, refer to the V-8HD Reference Manual, “Menu List” (PDF).

Name	Explanation
<b>1</b> Display-change button	Tap the button to switch the display.
<b>2</b> Operation panel	Operates the operation panel on the V-8HD by remote control.
<b>A</b> [OUTPUT FADE] knob	When you tap the function name shown at the lower left or lower right of the knob, a window opens, allowing you to change the function of turning the knob left or right.
<b>B</b> FREEZE [SETUP] button	Accesses the freeze function setup screen. 
<b>C</b> PinP 1 [SETUP] button	Accesses the PinP 1 and PinP 2 setup screen. 
<b>D</b> PinP 2 [SETUP] button	
<b>E</b> DSK [SETUP] button	Accesses the DSK setup screen. 
<b>F</b> [REC CONTROL] button	If a recorder that supports the “HDMI REC TRIGGER” function is connected to the output of the V-8HD, this controls start/stop for video recording on the recorder.
<b>G</b> AUTO SWITCHING [SETUP] button	Accesses the auto switching setup screen. 
AUTO SWITCHING [ON] button	Turns the auto switching on/off.
<b>H</b> TRANSITION TYPE [MIX] [WIPE] buttons	Switches to the MIX or WIPE setting items. 
TRANSITION TIME [-] [+] buttons	Specifies the video transition time.

Name	Explanation
<b>I</b> [INPUT ASSIGN] button	Accesses the INPUT ASSIGN (input source selection) setup screen. 
<b>J</b> SPLIT/VFX A [SETUP] button	Accesses the SPLIT/VFX A and SPLIT/VFX B setup screen. 
<b>K</b> SPLIT/VFX B [SETUP] button	
[CUT] button	When you tap the function name shown above or below the button, a window opens, allowing you to change the function of the button. <b>For the [CUT] button:</b> If the function is set to something other than “CUT,” the button name indication changes.
<b>L</b> [AUTO] button	<b>For the [AUTO] button:</b> If the function is set to something other than “AUTO,” the button name indication changes.
<b>3</b> PRESET MEMORY	When you tap a button (button lit), the saved settings are recalled. * The following settings are not saved in memory. Only one set of these settings are saved for the V-8HD unit. <ul style="list-style-type: none"><li>RESET MEMORY menu</li><li>CTL/EXP menu</li><li>STILL IMAGE menu</li><li>SYSTEM menu</li></ul>
[1]–[8] buttons	
[SAVE] button	If you tap the [SAVE] button (making it light) and then tap a [1]–[8] button, the state of the operating panel is saved to the memory you tapped.
[INIT] button	If you tap the [INIT] button (making it light) and then tap a [1]–[8] button, the content of the memory you tapped is initialized.
<b>4</b> CONNECT	This displays the connection status of the V-8HD and iPad. If this is “ONLINE,” you can remotely control the V-8HD from V-8HD Remote. 

Name	Explanation
<b>5</b> [MENU] button	This displays the settings screen (menu) of the V-8HD unit. Tap the [Back] button to return to the previous screen. * Some of the parameters cannot be edited from V-8HD Remote. 
<b>6</b> STILL IMAGE OUTPUT	
[1]–[8] buttons	When you tap a button (button lit), the output video switches to the specified still image.
<b>7</b> Audio mixer	Selects the channel for which you can edit the character of the sound. The setup screen for the channel selected by the [SETUP] button appears. 
[SETUP] button	
Level meter	These display the volume levels of input/output audio.
FOLLOW indicator	This is lit if the audio follow function is turned on.
[SOLO] button	Turns the solo function on/off.
[MUTE] button	Turns the mute function on/off.
Audio level faders	Adjusts the volume level of input/output audio.